

- KEY NOTES**
(NOTE: THESE NOTES MAY NOT APPEAR ON ALL SHEETS)
1. PROTECT IN PLACE.
 2. ROOF MOUNTED PANEL. PROTECT PANEL IN PLACE.

SHEET NOTES

1. CONTRACTOR SHALL CALL UNDERGROUND SERVICE ALERT (USA) AT 811 TO LOCATE UNDERGROUND UTILITIES AT LEAST 2 WORKING DAYS PRIOR TO DIGGING. CONTRACTOR SHALL FIELD VERIFY LOCATION AND DEPTH OF EXISTING IMPROVEMENTS PRIOR TO START OF CONSTRUCTION.
2. VERIFY LOCATION OF ALL BUILDINGS AND APERTURES ON ARCHITECTURAL AND CIVIL PLANS.
3. FIELD VERIFY LOCATION ON ALL UNDERGROUND UTILITIES PRIOR TO TRENCHING, SCHEDULE AND COORDINATE ALL SITE WORK WITH OWNER PRIOR TO ANY TRENCHING.
4. CONTRACTOR SHALL VERIFY LOCATION & REQUIREMENTS OF ALL DEVICES/EQUIPMENT REQUIRING ELECTRICAL CONNECTION PRIOR TO BID PROPOSAL, REVISION AND FINISH.
5. CONTRACTOR SHALL IN ROUTING ALL CIRCUITS, INCREASE CONDUIT & CONDUIT SIZE TO ALLOW FOR FUTURE GROW SHOULD THE CONTRACTOR EXCEED ROUTING INDICATED ON DRAWINGS. ENGINEER OF RECORD MUST BE NOTIFIED PRIOR TO ANY DEVIATIONS FROM APPROVED PLAN CHECK (PERMIT SET) DRAWINGS.
6. ALL 90 DEGREE CONDUIT BENDS AND RISERS SHALL BE PVC COATED RIBBON STEEL.
7. CONTRACTOR SHALL COORDINATE AND PROVIDE ALL SITE ELECTRICAL SERVICE REQUIREMENTS WITH SERVING UTILITY.
8. ALL SERVICE ENTRANCE EQUIPMENT SHOP DRAWINGS SHALL BE SUBMITTED TO THE LOCAL UTILITY COMPANY FOR APPROVAL, WITH WRITTEN APPROVAL RECEIVED PRIOR TO SUBMISSION TO ELECTRICAL ENGINEER FOR APPROVAL.
9. VERIFY LOCATION OF ALL EQUIPMENT ON ARCHITECTURAL AND CIVIL PLANS.
10. MINIMUM CONDUIT BURIAL DEPTH IS 24", 36" MINIMUM BELOW STREETS AND PARKING LOTS, FOR 0-600 VOLT SYSTEMS.
11. PROVIDE CODE SIZED EQUIPMENT GROUNDING CONDUCTORS IN ALL OCCUPIED CONDITS.
12. 1" CONDUIT MINIMUM UNDERGROUND.
13. COORDINATE WORK WITH OTHER TRADES. OBTAIN ALL DRAWINGS THAT WILL REQUIRE COORDINATION AND PROVIDE ALL ELECTRICAL CONNECTIONS, DEVICES, AND WIRING REQUIRED, WHETHER SHOWN ON THE ELECTRICAL DRAWINGS OR NOT.
14. CONTRACTOR SHALL FURNISH AND INSTALL PULL BOXES AS REQUIRED TO INSTALL CONDUCTORS PER CONDUIT MANUFACTURERS RECOMMENDATIONS, PER THE NATIONAL ELECTRICAL CODE, AND PER LOCAL AUTHORITIES HAVING JURISDICTION.
15. FIELD CONDITIONS GOVERN DEMOLITION AND NEW CONSTRUCTION. CONTRACTOR SHALL VERIFY ACTUAL CONDITIONS PRIOR TO START OF WORK. THE ARCHITECT/ENGINEER SHALL BE NOTIFIED OF POSSIBLE FIELD PROBLEMS PRIOR TO DEMOLITION. CONTRACTOR SHALL NOTIFY DISTRICT REPRESENTATIVE OF WORK BEING PERFORMED. COORDINATE WITH DISTRICT REPRESENTATIVE.
16. ALL EMPTY CONDUITS SHALL BE PROVIDED WITH DIMENSIONED NYLON FULL STRING.
17. CONTRACTOR SHALL FIELD VERIFY LOCATION OF ALL UNDERGROUND UTILITIES PRIOR TO ANY EXCAVATION OR TRENCHING. CONTRACTOR SHALL PROTECT ALL EXISTING/REMAINING UTILITIES IN PLACE. CONTRACTOR, AT HIS SOLE EXPENSE, SHALL REPAIR ANY UTILITY SYSTEMS DAMAGED DURING CONSTRUCTION.
18. VERIFY AND PROVIDE ALL UTILITY SYSTEMS PER SERVING UTILITY STANDARD REQUIREMENTS.
19. CONTRACTOR SHALL PROVIDE CONCRETE ENCASUREMENT AT ALL VERIZON COMPANY CONDUIT BENDS PER VERIZON COMPANY REQUIREMENTS.

NOTE:
IT IS THE CONTRACTOR'S RESPONSIBILITY TO REVIEW ALL CIVIL ENGINEERING DRAWINGS AND SITE AS-BUILTS (OBTAIN FROM OWNER) TO IDENTIFY THE LOCATION AND ROUTING OF ALL EXISTING UNDERGROUND UTILITIES, METERS, DRAINS, LANDSCAPING AND STRUCTURAL OBSTACLES PRIOR TO TRENCHING AND CONDUIT DUCT BANK ROUTING. THE CONTRACTOR SHALL CONDUCT AN UNDERGROUND SCAN OF THE CORRIDOR WHERE NEW TRENCHING SHALL OCCUR, AND TO COORDINATE THE ROUTING OF NEW TRENCHING IN AREAS OF EXISTING UNDERGROUND UTILITIES. TRENCHING FOR NEW UNDERGROUND CONDUITS IN AREAS WHERE EXISTING UNDERGROUND UTILITIES ARE PRESENT, WHETHER SHOWN ON THESE PLANS OR NOT, SHALL BE EXCAVATED BY HAND AND WITH EXTREME CAUTION SO AS NOT TO DISTURB EXISTING UTILITIES. CONTRACTOR SHALL PROMPTLY REPAIR DAMAGE TO OWNER'S SATISFACTION. UNDERGROUND POWER AND COMMUNICATION PULL BOXES WHERE SHOWN ON THE SITE PLAN TO BE RELOCATED TO A POSITION AS CLOSE AS POSSIBLE TO THE LOCATION SHOWN ON THE DRAWING. CONTRACTOR SHALL PROMPTLY NOTIFY OWNER IF ANY EXISTING UTILITY OR IRRIGATION LINE IS DAMAGED, AND SHALL PROMPTLY REPAIR DAMAGE TO OWNER'S SATISFACTION.

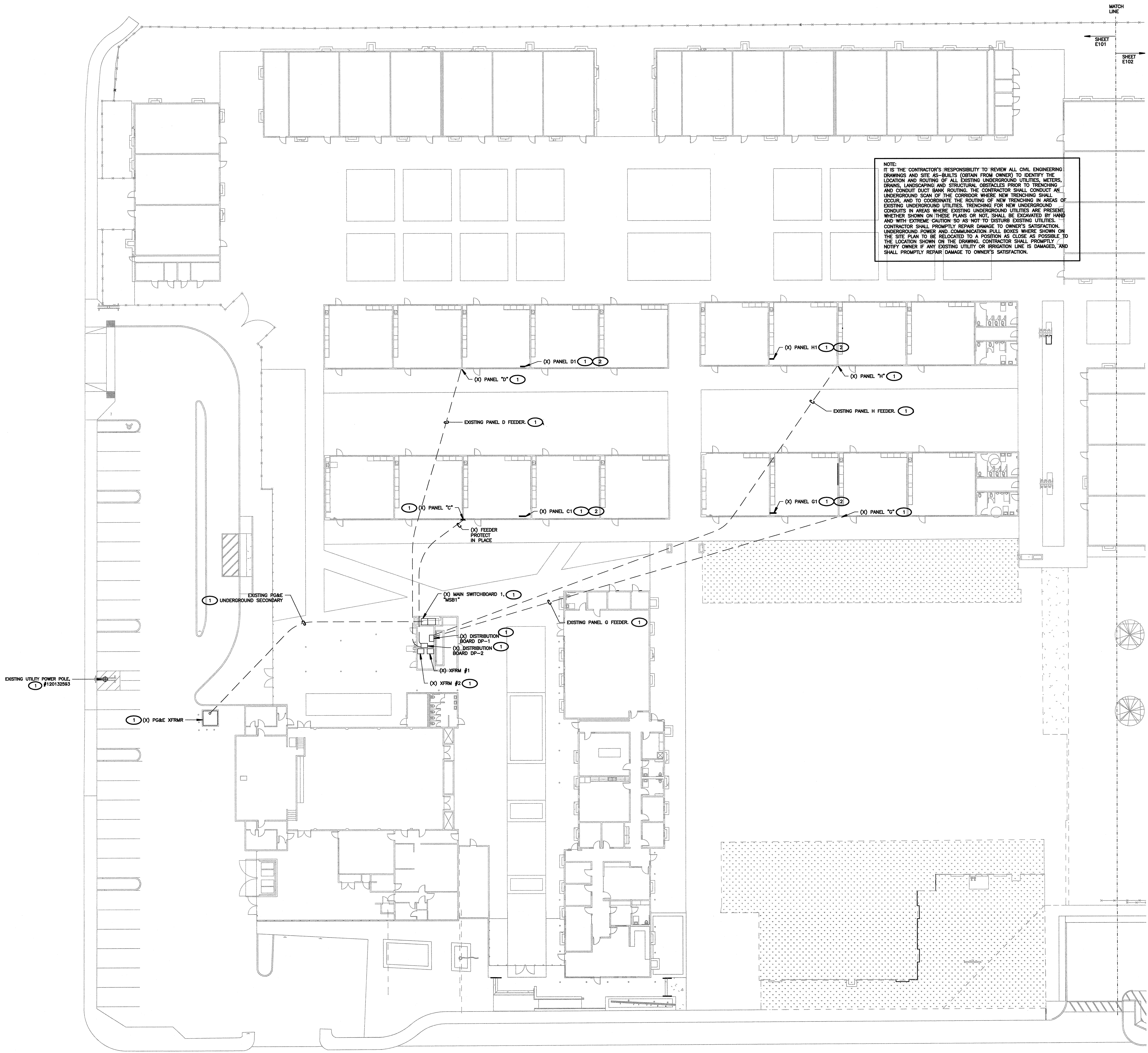

AGENCY INFORMATION:

AGENCY TRACKING NO. 63321-356
FILE NO. 15-6

IDENTIFICATION STAMP
DIV. OF THE STATE ARCHITECT
OFFICE OF REGULATION SERVICES
03-120240
AC IV FL 22 SS 1
DATE JAN 02 2020

SEAL

COPYRIGHT:
Any reproduction or distribution for any purpose other than authorized by IBI Group is forbidden.

COPYRIGHT 2019 IBI GROUP

REVISIONS

NO.	DATE SUBMITTED	DATE APPROVED	DESCRIPTION

CONSULTANT
FERRANTI ENGINEERING
CONSULTING ELECTRICAL ENGINEERS
1211 MARIOPA HWY,
SUITE 250
OJAI, CA 93023
(805) 705-4772
DALEFERRANTI@LIVE.COM

PRIME CONSULTANT
IBI ARCHITECTURE PLANNING
San Luis Obispo
4119 Broad Street, Suite 210
San Luis Obispo, CA 93401
805.546.0433
fax: 805.546.0504
ibigroup.com

BAKERSFIELD CITY SCHOOL DISTRICT

BESSIE OWENS E.S. KINDERGARTEN MODULAR BUILDINGS
815 POTOMAC AVE, BAKERSFIELD, CA 93307

OPSC or OSHPD PROJ. NO. N/A
PROJECT NO. 118932
DRAWN BY: V.Z.
CHK'D BY: D.F.
ISSUE DATE: 10/29/2019

SHEET TITLE
PARTIAL SITE ELECTRICAL PLAN (EXISTING) SHEET #1

SHEET NUMBER
E101

1 PARTIAL SITE ELECTRICAL EXISTING PLAN
SCALE: 1" = 20'-0"



CONSTRUCTION DOCUMENTS