

GENERAL NOTES

- REFER TO CIVIL, PLUMBING, AND ELECTRICAL DRAWINGS FOR UNDERGROUND UTILITIES.
- PRIOR TO ANY UNDERGROUND SITE WORK, VERIFY LOCATION OF ALL EXISTING UTILITIES WITH UNDERGROUND SERVICE ALERT (U.S.A.).
- REFER TO SHEET 2A1200 FOR CONTROL JOINT AND EXPANSION JOINT LOCATIONS.
- CHAINLINK POSTS - 4" W/4" FROM ANCHOR BULLDOZER

KEYNOTES

- 1144 (E) MARQUEE SIGN TO REMAIN
- 1180 SINGLE POST UMBRELLA PER PC #804-117140
- 1183 ACCESSIBLE CHAINLINK GATE PER DETAIL 12A8000
- 1184 CHAINLINK FENCE PER DETAIL 72A8000
- 1186 SEE DETAIL 152A8001 FOR TYPICAL DOOR REQUIREMENTS
- 1187 DRYWELL PER DETAIL 22A8001
- 1188 HVAC MOUNTING HEIGHT PER DETAIL 212A8001
- 1189 DRYWELL DRAIN BELOW PER DETAIL 10, A 1204
- 1190 NEWEXISTING CUTLINE
- 1210 (E) BACKFLOW PREVENTER TO REMAIN, SEE LANDSCAPE
- 1252 ELECTRICAL EQUIPMENT, SEE ELECTRICAL
- 1253 BOOSTER PUMP, SEE LANDSCAPE DRAWINGS, SEE DETAIL 132A8001 FOR ANCHORAGE
- 1254 (E) SLAB (6")

LEGEND

- NOTE: NOT ALL GRAPHICS & SYMBOLS OCCUR IN THIS SHEET
- ASSUMED PROPERTY LINE
 - CHAINLINK FENCE PER DETAIL 62A8000
 - ACCESSIBLE PATH OF TRAVEL AS INDICATED ON PLAN IS A BARRIER-FREE ACCESS ROUTE AT LEAST 48" WIDE, WITHOUT ANY ABRUPT VERTICAL CHANGES EXCEEDING 1/2" AT 1:2 MAX. SLOPE, EXCEPT LEVEL CHANGES THAT DO NOT EXCEED 2% AND SLOPES IN THE DIRECTION OF TRAVEL SHALL NOT EXCEED 5%. "PASSING SPACES" AT LEAST 60"x80" ARE LOCATED NOT MORE THAN 200' APART. PART OF ACCESSIBLE PATH OF TRAVEL WITH CONTINUOUS GRADIENTS HAVE 60" LEVEL AREAS NOT MORE THAN 400' APART. P.O.T. SHALL BE FREE OF OBSTRUCTIONS OVERHANGING WITHIN 80" ABOVE WALKING SURFACE AND PROJECTING GREATER THAN 4" FROM WALL SURFACES BETWEEN 27" AND 80" ABOVE WALKING SURFACE. CBC 11B-307.2
 - THE ARCHITECT SHALL VERIFY THAT ALL BARRIERS ON THE INDICATED PATH OF TRAVEL HAVE BEEN REMOVED. GATES IN PATH OF TRAVEL SHALL COMPLY WITH EXIT DOOR REQUIREMENTS PER CBC SECTION 11B-404.1
 - ↓ ACCESSIBLE BUILDING ENTRANCE
 - EXISTING BUILDING TO REMAIN
 - ▨ NEW MODULAR BUILDING TO BE CONSTRUCTED AS PART OF DSA APPLICATION NUMBER AND CONTRACT
 - ▨ ACCESSIBLE/UNISEX STUDENT OR STAFF RESTROOM PER DSA APPLICATION NUMBER AS INDICATED (S - TEACHER/STAFF, U - UNISEX STUDENT)
 - ▨ PATTERNED CONCRETE WALK, MEDIUM BROOM FINISH.
 - ▨ PLAY SURFACE, SEE DETAIL 8 / 2A8001
 - ▨ AC PAVING, SEE CIVIL DRAWINGS FOR PAVEMENT SECTION.
 - ▨ TURF, SEE LANDSCAPE DRAWINGS

KEY PLAN

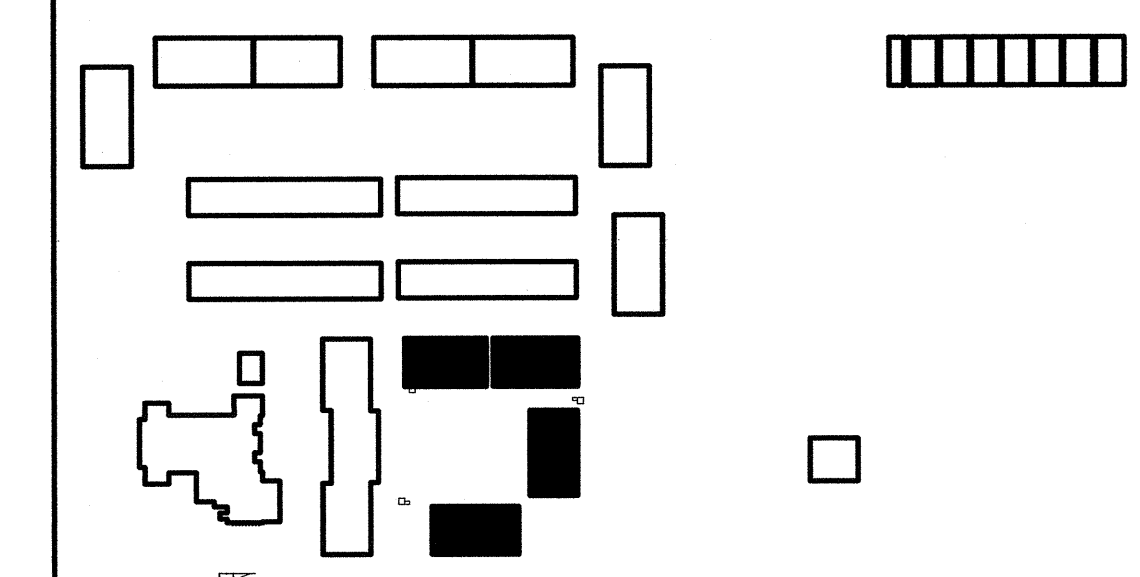

AGENCY INFORMATION:

AGENCY TRACKING NO. 63321-356
FILE NO. 15-6

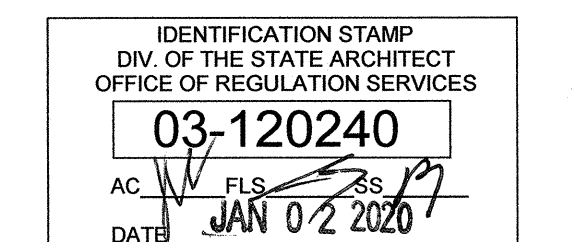

SEAL



COPYRIGHT:

Any reproduction or distribution for any purpose other than authorized by IBI Group is forbidden.

COPYRIGHT 2019 IBI GROUP

REVISIONS			
NO.	DATE SUBMITTED	DATE APPROVED	DESCRIPTION

CONSULTANT

PRIME CONSULTANT

IBI ARCHITECTURE PLANNING
San Luis Obispo
4119 Broad Street, Suite 210
San Luis Obispo, CA 93401
805.545.0433 fax: 805.546.0504
ibigroup.com

BAKERSFIELD CITY SCHOOL DISTRICT

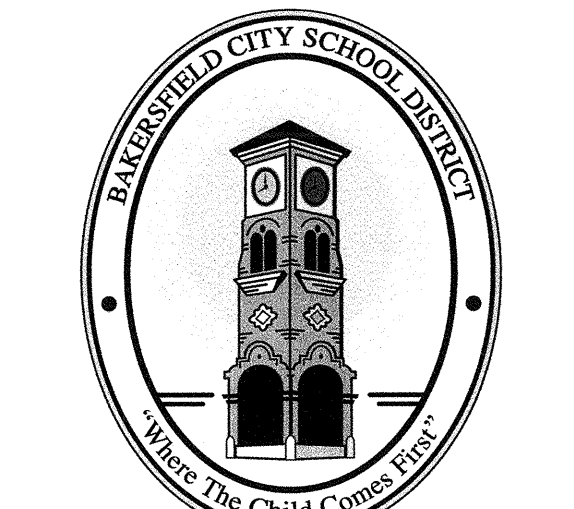

BESSIE OWENS E.S. KINDERGARTEN MODULAR BUILDINGS

815 POTOMAC AVE, BAKERSFIELD, CA 93307

OPSC or OSHPD PROJ. NO.	N/A
PROJECT NO.	19122.00-38
DRAWN BY:	CZ
CHKD BY:	rRr
ISSUE DATE:	11/05/2019

ENLARGED SITE PLAN

SHEET NUMBER

2A1101

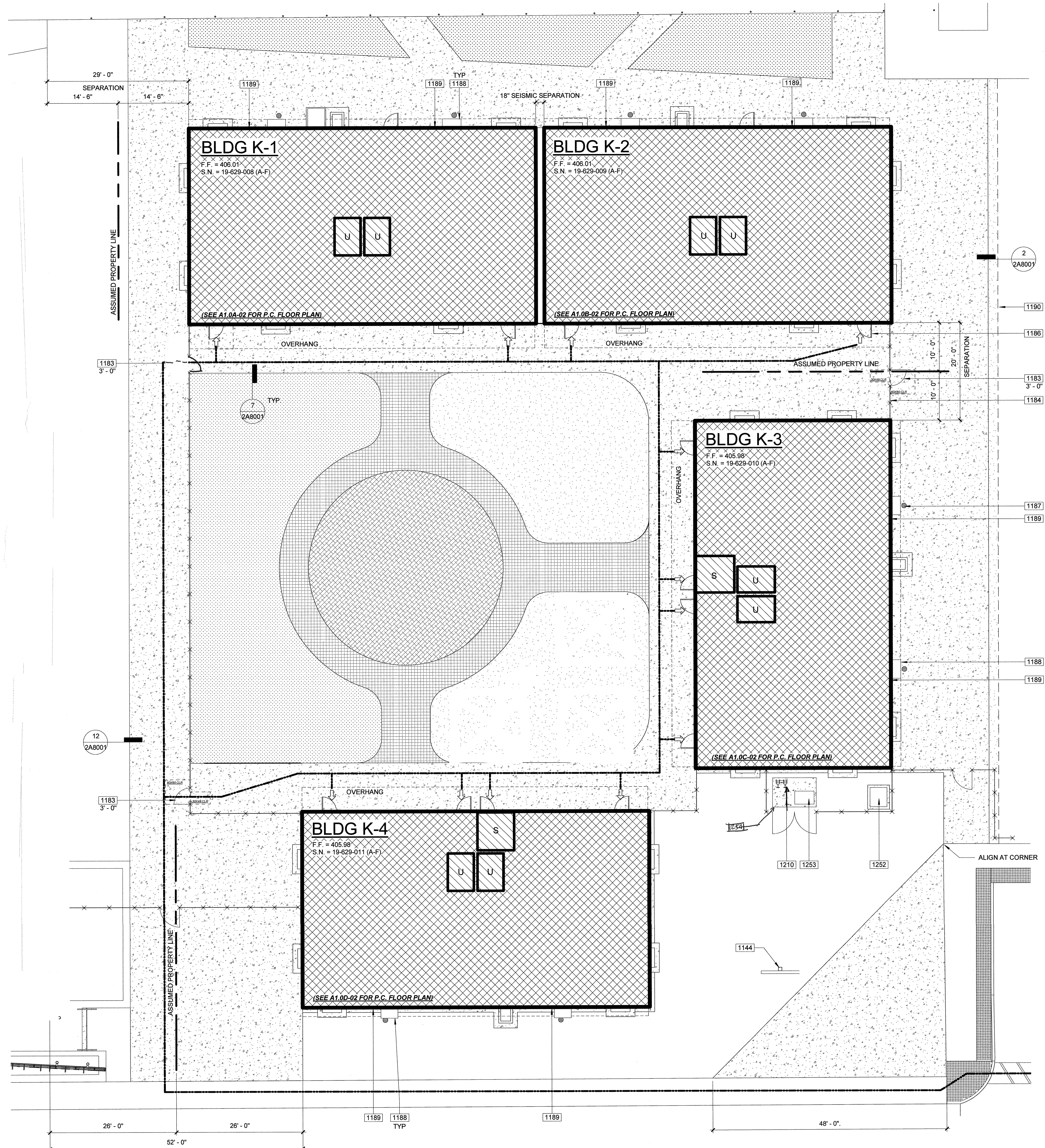

1 SITE PLAN
1" = 10'-0"

