

PANEL D

OUTLET'S	CONNECTED LOAD	REARERS	NOTES
CCT	LIGHT	MATTS	APP. FOLE
1	3	1,200	
2	3	1,200	
3	3	1,200	
4	3	1,200	
5	3	1,200	
6	3	1,200	
7	3	1,200	
8	3	1,200	
9	3	1,200	
10	3	1,200	
11	3	1,200	
12	3	1,200	
13	3	1,200	
14	3	1,200	
15	3	1,200	
16	3	1,200	
17	3	1,200	
18	3	1,200	
19	3	1,200	
20	3	1,200	
21	3	1,200	
22	3	1,200	
23	3	1,200	
24	3	1,200	
25	3	1,200	
26	3	1,200	
27	3	1,200	
28	3	1,200	
29	3	1,200	
30	3	1,200	
TOTAL		36,000	

PANEL E

OUTLET'S	CONNECTED LOAD	REARERS	NOTES
CCT	LIGHT	MATTS	APP. FOLE
1	3	1,200	
2	3	1,200	
3	3	1,200	
4	3	1,200	
5	3	1,200	
6	3	1,200	
7	3	1,200	
8	3	1,200	
9	3	1,200	
10	3	1,200	
11	3	1,200	
12	3	1,200	
13	3	1,200	
14	3	1,200	
15	3	1,200	
16	3	1,200	
17	3	1,200	
18	3	1,200	
19	3	1,200	
20	3	1,200	
21	3	1,200	
22	3	1,200	
23	3	1,200	
24	3	1,200	
25	3	1,200	
26	3	1,200	
27	3	1,200	
28	3	1,200	
29	3	1,200	
30	3	1,200	
TOTAL		36,000	

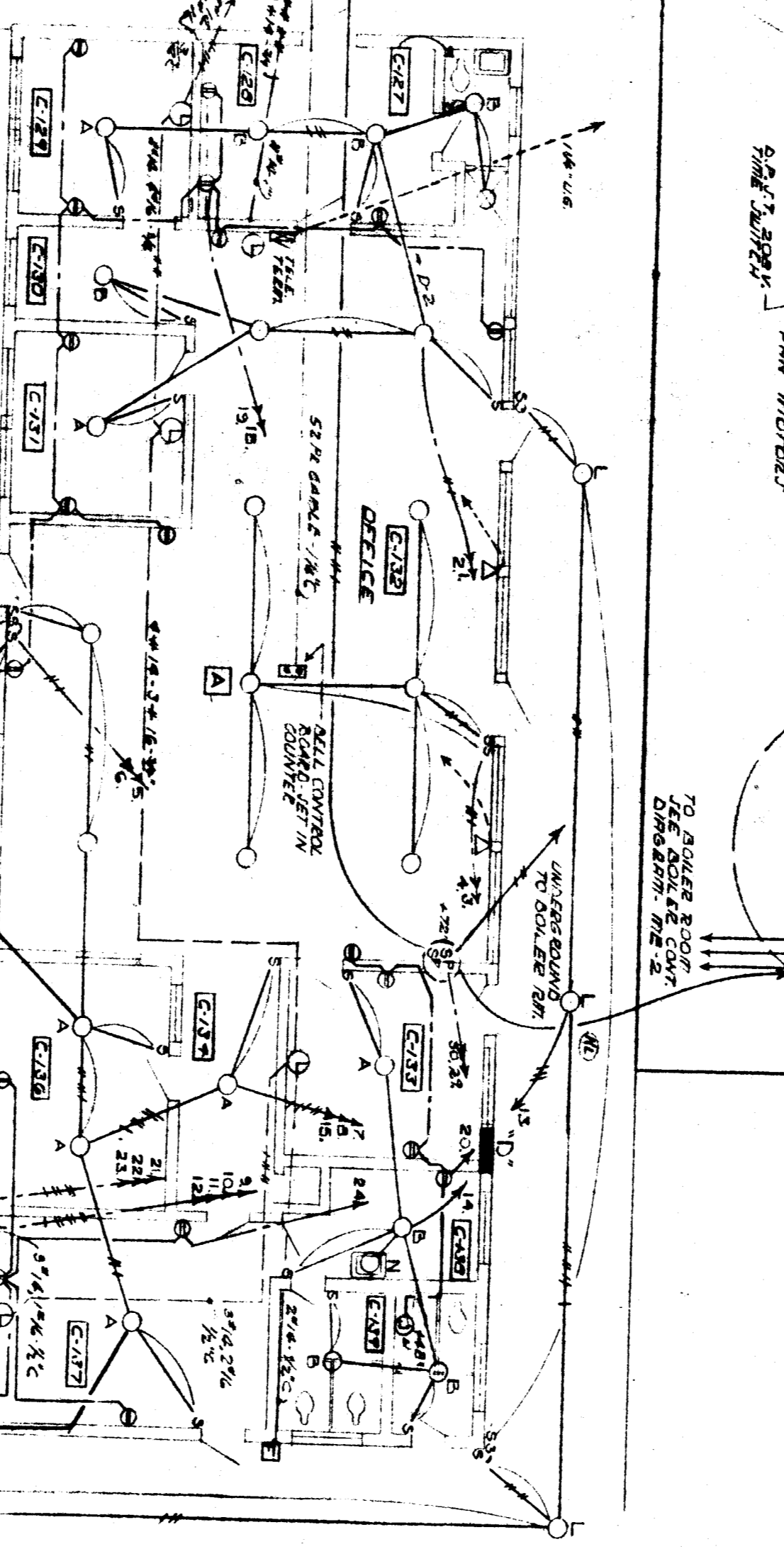
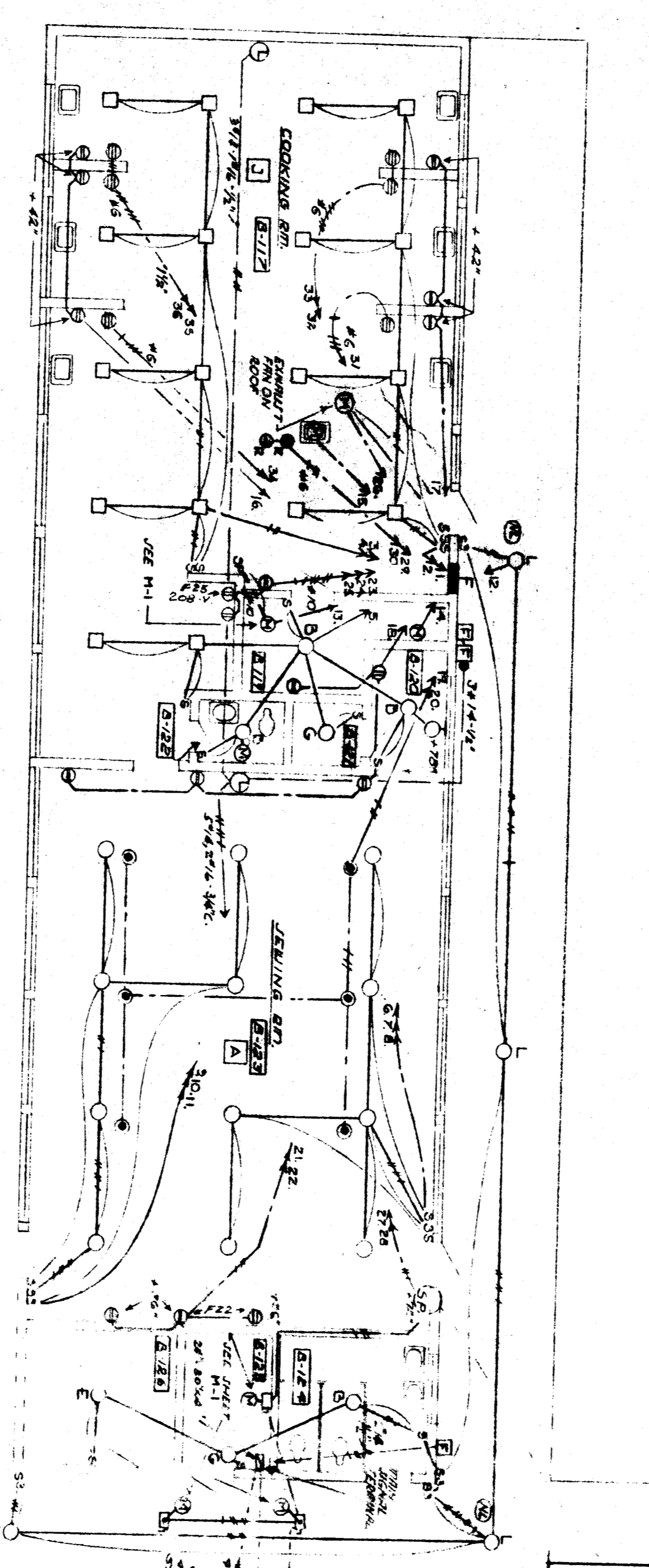

PANEL F

OUTLET'S	CONNECTED LOAD	REARERS	NOTES
CCT	LIGHT	MATTS	APP. FOLE
1	3	1,200	
2	3	1,200	
3	3	1,200	
4	3	1,200	
5	3	1,200	
6	3	1,200	
7	3	1,200	
8	3	1,200	
9	3	1,200	
10	3	1,200	
11	3	1,200	
12	3	1,200	
13	3	1,200	
14	3	1,200	
15	3	1,200	
16	3	1,200	
17	3	1,200	
18	3	1,200	
19	3	1,200	
20	3	1,200	
21	3	1,200	
22	3	1,200	
23	3	1,200	
24	3	1,200	
25	3	1,200	
26	3	1,200	
27	3	1,200	
28	3	1,200	
29	3	1,200	
30	3	1,200	
TOTAL		36,000	

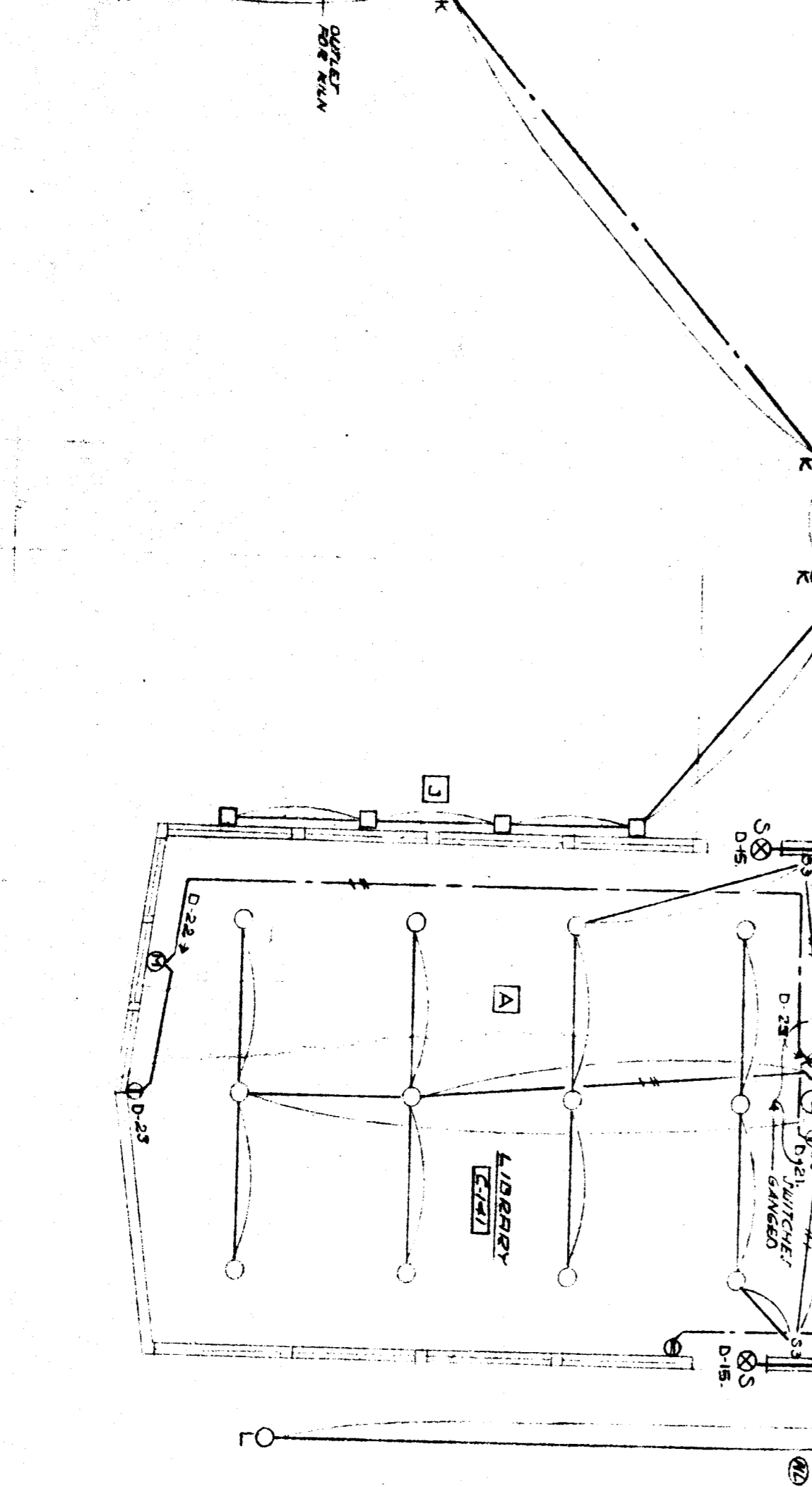
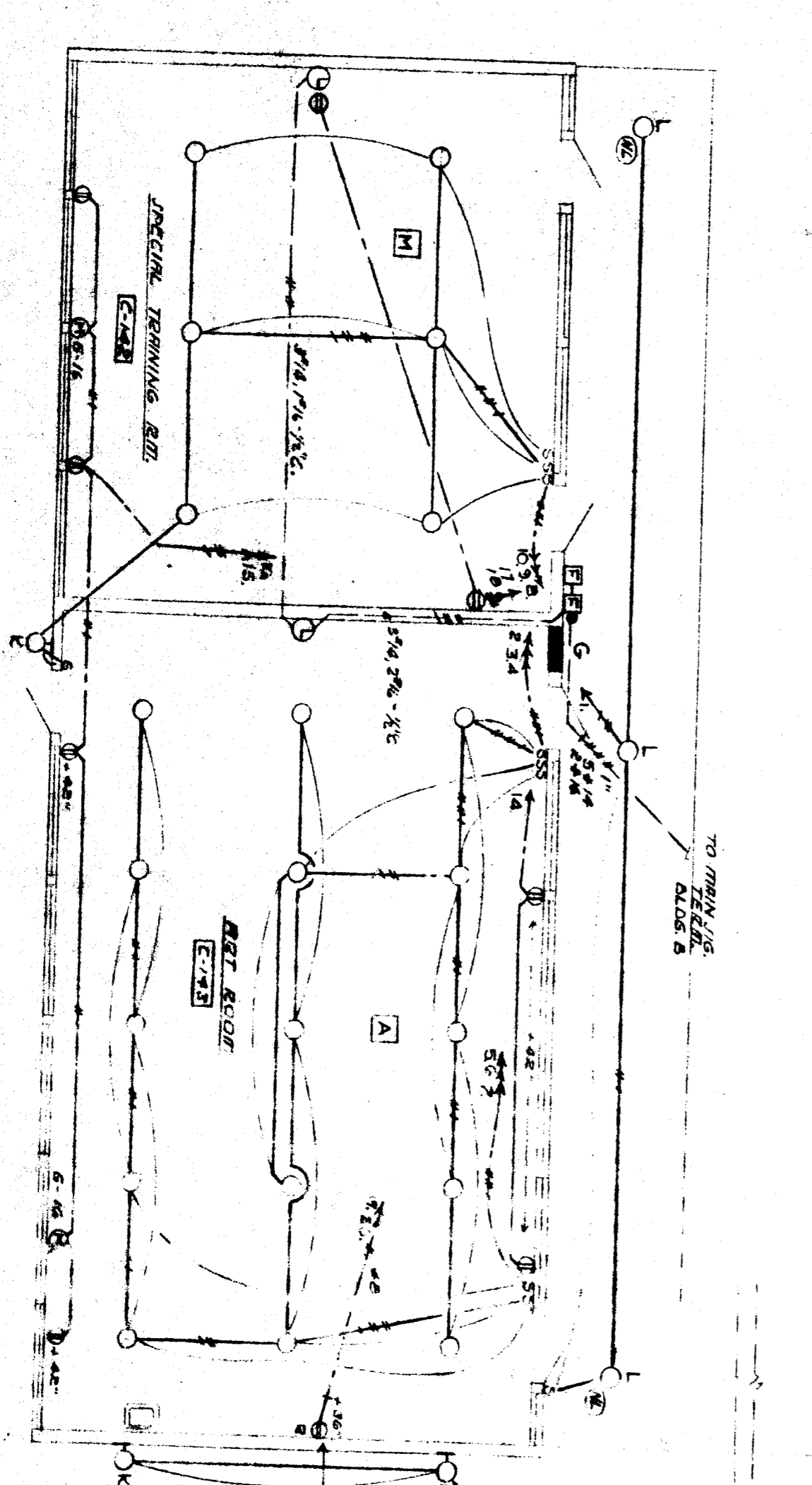

PANEL G

OUTLET'S	CONNECTED LOAD	REARERS	NOTES
CCT	LIGHT	MATTS	APP. FOLE
1	3	1,200	
2	3	1,200	
3	3	1,200	
4	3	1,200	
5	3	1,200	
6	3	1,200	
7	3	1,200	
8	3	1,200	
9	3	1,200	
10	3	1,200	
11	3	1,200	
12	3	1,200	
13	3	1,200	
14	3	1,200	
15	3	1,200	
16	3	1,200	
17	3	1,200	
18	3	1,200	
19	3	1,200	
20	3	1,200	
21	3	1,200	
22	3	1,200	
23	3	1,200	
24	3	1,200	
25	3	1,200	
26	3	1,200	
27	3	1,200	
28	3	1,200	
29	3	1,200	
30	3	1,200	
TOTAL		36,000	

W. A. STAINS
 CONSULTING ENGINEER
 1603 CALIFORNIA AVENUE
 BAKERSFIELD, CALIFORNIA

ROBERT N. EDDY
 ARCHITECT R.I.R.
 2901 H. ST. BAKERSFIELD CALIFORNIA PH 59046

SHOP-HOME ECONOMICS-OFFICE AND BRT BUILDINGS AND SCHEDULES ELECTRICAL
 LINCOLN JUNIOR HIGH SCHOOL
 BAKERSFIELD DISTRICT CALIFORNIA

KERN CO. SUPERINTENDENT OF SCHOOLS APPROVED
 DATE 10-26-53

DATE 9-30-53 DRAWN
 JOB NO. 117-653 CHECKED
 ARCHITECT Robert N. Eddy C. 895

APPROVED OCT 21 1953
 11314