

- SIGNAL FEEDER SYMBOLS**
- 1 - 1/2" x 1/4" x 10' #12
 - 2 - 1/2" x 1/4" x 11'
 - 3 - 1/2" x 1/4" x 12'
 - 4 - 1/2" x 1/4" x 13'
 - 5 - 1/2" x 1/4" x 14'
 - 6 - 1/2" x 1/4" x 15'
 - 7 - 1/2" x 1/4" x 16'
 - 8 - 1/2" x 1/4" x 17'
 - 9 - 1/2" x 1/4" x 18'
 - 10 - 1/2" x 1/4" x 19'
 - 11 - 1/2" x 1/4" x 20'
 - 12 - 1/2" x 1/4" x 21'
 - 13 - 1/2" x 1/4" x 22'
 - 14 - 1/2" x 1/4" x 23'
 - 15 - 1/2" x 1/4" x 24'
 - 16 - 1/2" x 1/4" x 25'

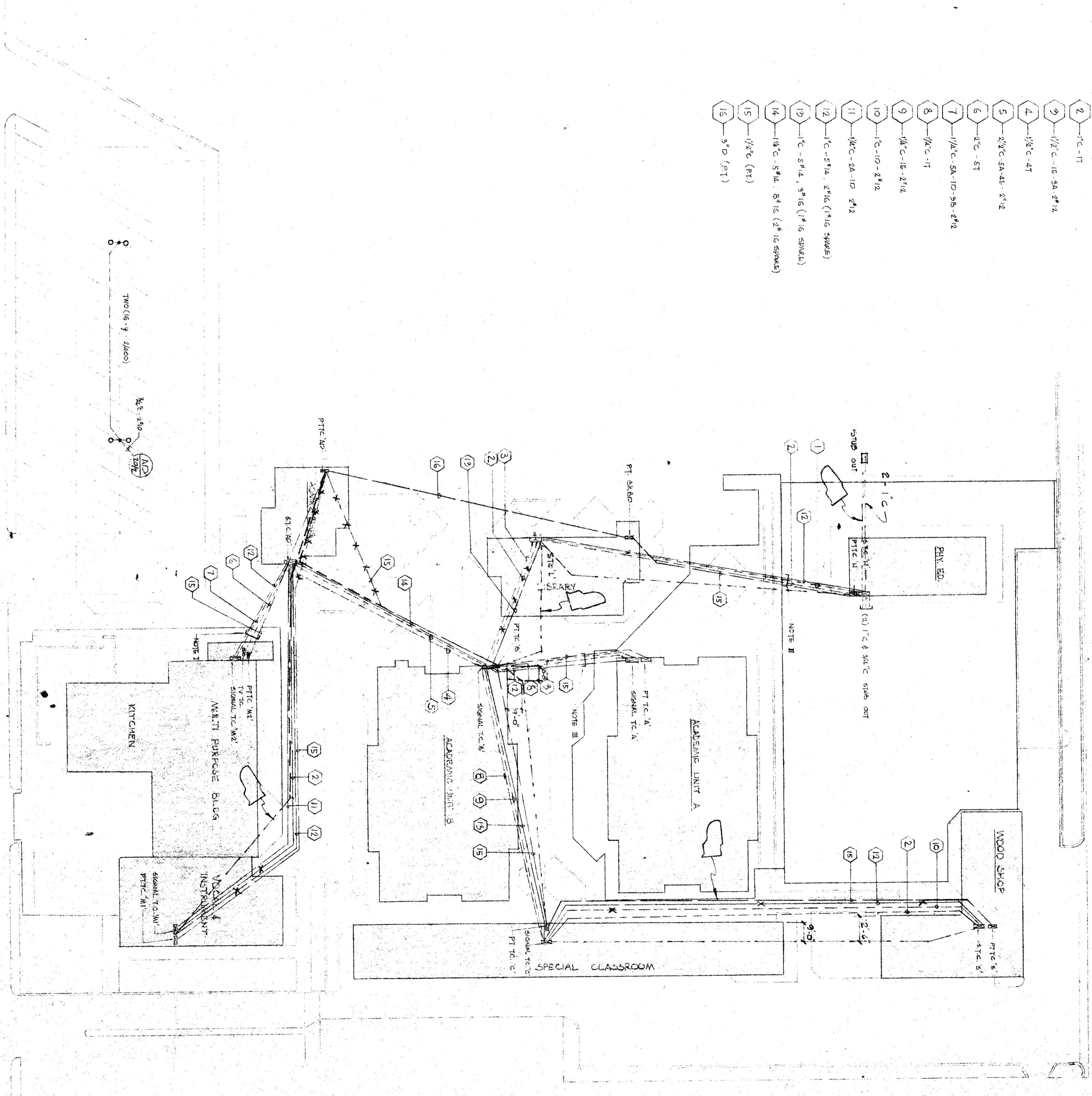
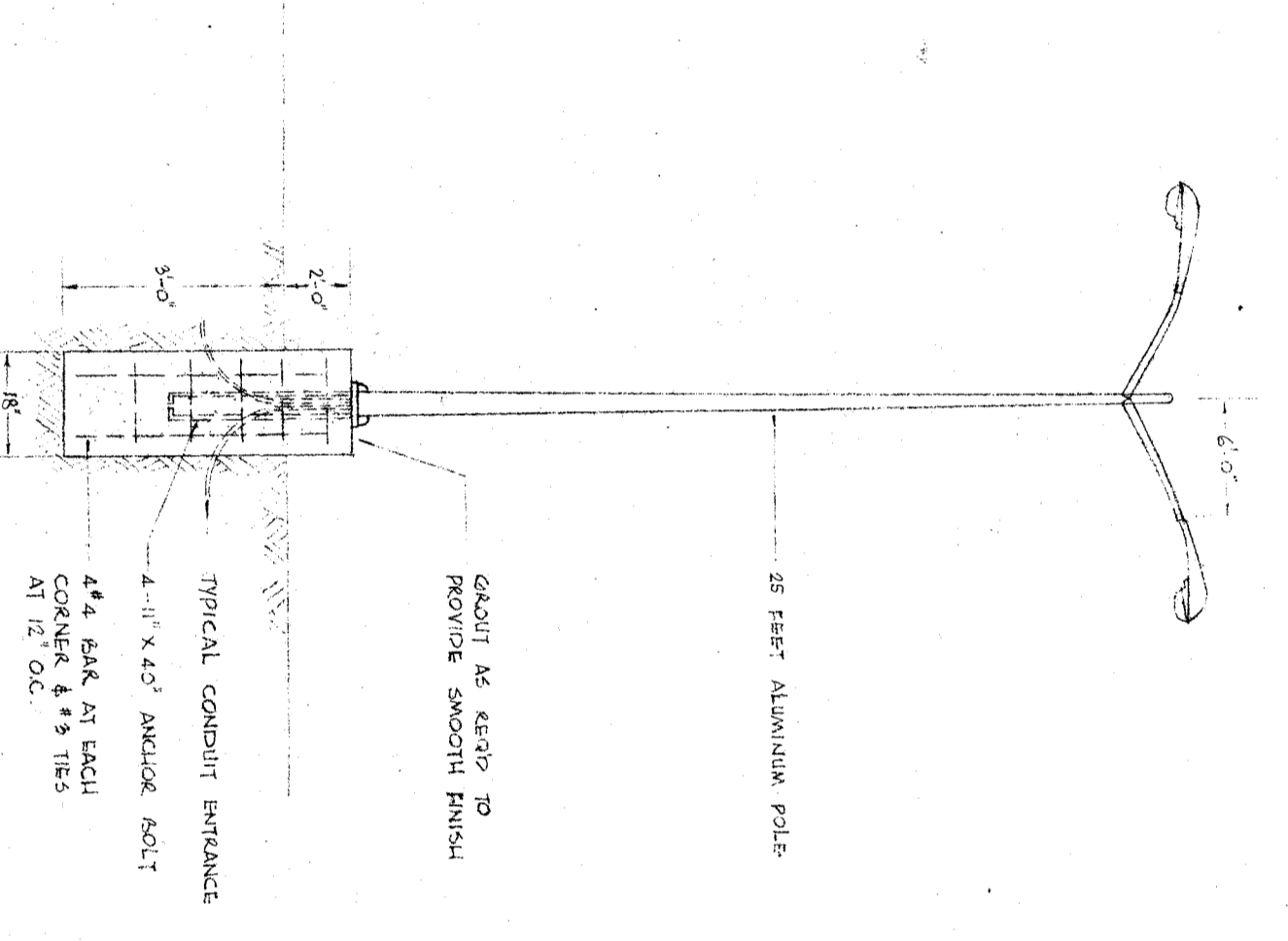

NOTE

- (1) 5/8" DIA. CWT WITH CONCRETE ONLY SET AS NOTED
- (2) IF AVAILABLE, TWO #4'S IS ACCEPTED
- (3) 5/8" DIA. CWT WITH CONCRETE ONLY SET AS NOTED
- (4) IF AVAILABLE, TWO #4'S IS ACCEPTED
- (5) 5/8" DIA. CWT WITH CONCRETE ONLY SET AS NOTED
- (6) IF AVAILABLE, TWO #4'S IS ACCEPTED

APPROVED JUL 25 - 1983
30409

CHECK AND VERIFY ALL DIMENSIONS AND CONDITIONS AT JOB SITE BEFORE PROCEEDING WITH THE WORK. REPORT ANY DISCREPANCIES TO THE ARCHITECT.	
DATE	BY
APPROVED - DATE	APPROVED - NAME
STATE OF CALIFORNIA STATE FIRE MARSHAL APPROVED UNDER STATUTES OF CALIFORNIA	EDWARD LOWE ELECTRICAL ENGINEER FRESNO CALIFORNIA
DATE	BY
APPROVED - DATE	APPROVED - NAME
STATE OF CALIFORNIA STATE FIRE MARSHAL APPROVED UNDER STATUTES OF CALIFORNIA	ERNEST L. MCCOY AIA ARCHITECT CALIFORNIA 1988
DATE	BY
APPROVED - DATE	APPROVED - NAME
STATE OF CALIFORNIA STATE FIRE MARSHAL APPROVED UNDER STATUTES OF CALIFORNIA	BERNICE HARRELL CHIPMAN JUNIOR HIGH SCHOOL BAKERSFIELD CITY SCHOOL DISTRICT CALIFORNIA