

IDENTIFICATION STAMP
 DIVISION OF STATE ARCHITECT
 OFFICE OF REGULATION SERVICES
 APPL. #: 02-112027
 FILE #: 15-6
 AC FEB 20 09
 DATE JAN 20 2012
 PTN # 63321-112

NEW ELEMENTARY SCHOOL
 9801 HIGHLAND KNOLLS DR
 BAKERSFIELD CALIFORNIA 93306
 NEW MIDDLE SCHOOL
 4115 VINELAND ROAD
 BAKERSFIELD CALIFORNIA 93306
 FOR:
 BAKERSFIELD CITY SCHOOL DISTRICT
 1300 BAKER STREET
 BAKERSFIELD CALIFORNIA 93305

MARK	DATE	DESCRIPTION
△		
△		
△		
△		

200101244
 CAD DRAWING FILE:
 DRAWN BY: KW
 CHECKED BY: MB
 CHECK AND VERIFY ALL DIMENSIONS BEFORE PROCEEDING WITH THE WORK. REPORT DISCREPANCIES TO THE ARCHITECT.
 THE DRAWINGS, IDEAS, AND DESIGNS REPRESENTED ON THIS SHEET ARE THE PROPERTY OF THE ARCHITECT.
 COPYRIGHT: ORDIZ-MELBY ARCHITECTS, INC 2010
 SHEET TITLE
MECHANICAL ROOF PLAN - BUILDING B

SHEET IDENTIFICATION NUMBER
M-141B

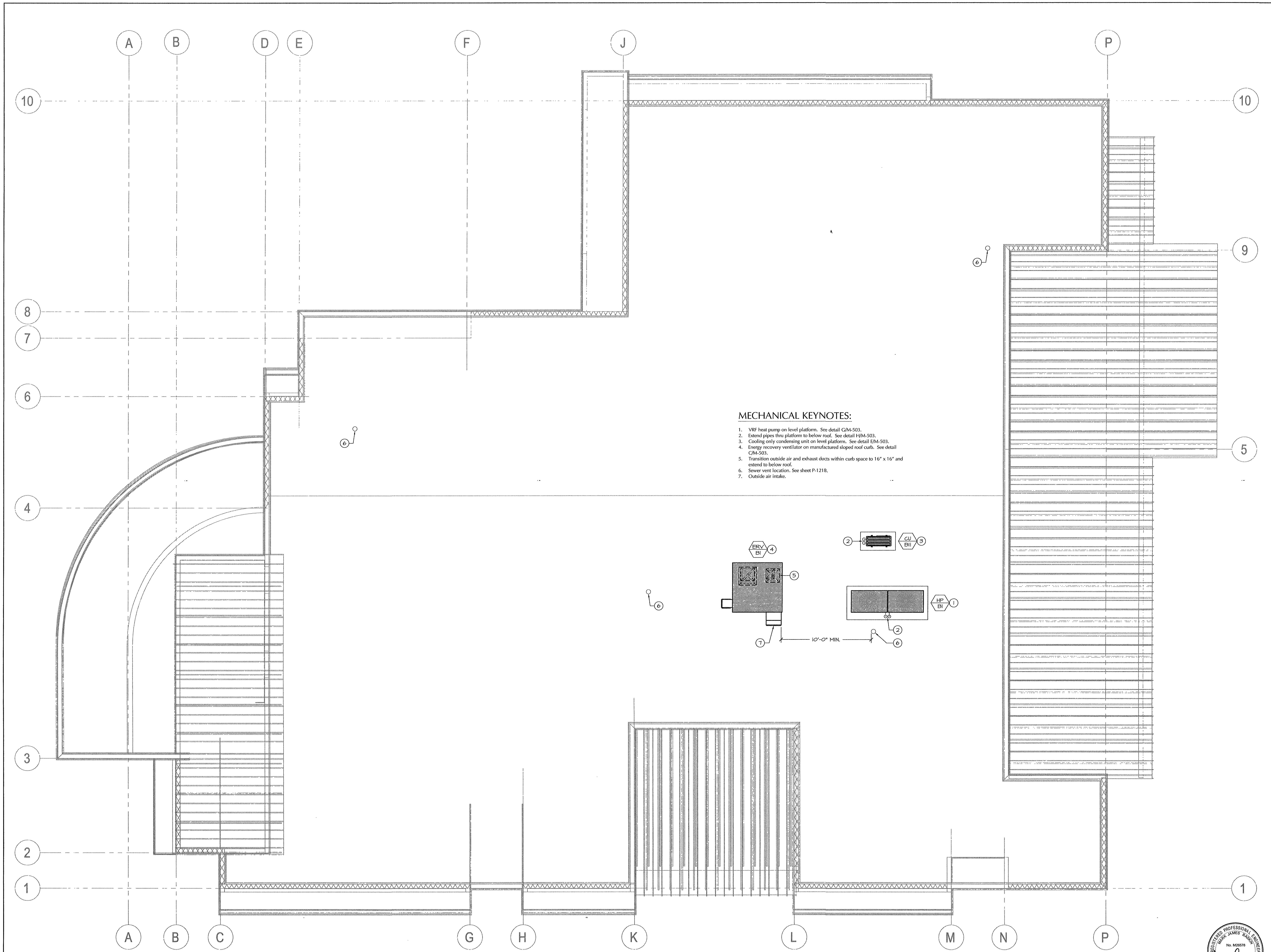

- MECHANICAL KEYNOTES:**
1. VRF heat pump on level platform. See detail GM-503.
 2. Extend pipes thru platform to below roof. See detail HM-503.
 3. Cooling only condensing unit on level platform. See detail EM-503.
 4. Energy recovery ventilator on manufactured sloped roof curb. See detail CM-503.
 5. Transition outside air and exhaust ducts within curb space to 16" x 16" and extend to below roof.
 6. Sewer vent location. See sheet P-121B.
 7. Outside air intake.

