

MECHANICAL KEYNOTES:

- 24"x16" supply and 36"x12" return ducts from AC-A4 with 2" acoustical liner.
- 24" x 14" supply and 32" x 12" return ducts from AC-A5 with 2" acoustical liner.
- 14" x 14" exhaust duct from EF-A6 with 1" acoustical liner.
- 12" round VAV damper with automatic heat/cool change-over. See detail AM-501.
- This grille located at 12'-0" A.F.F. to centerline of grille. Set horizontal front blades to 22-1/2 degrees downward deflection.
- Route duct thru block wall above door opening. Stack ducts to fit thru 36" wide opening. See structural plans for opening.
- Typical branch duct balancing damper. See detail FM-504.
- CR-1 return grille, typical at T-bar ceilings unless otherwise noted.
- Titus FL-10 flowbar diffuser with (1) 1" slot. Field built plenum with external insulation. Paint inside of plenum flat black. Provide duct taps as noted on plan. Radius to match radius of lobby wall and length as shown on plans. Approximately 60 CFM / Ft. Centerline of grille at 12'-0" above finished floor.
- See typical branch duct to diffuser connection EM-504.

PARTIAL MECHANICAL PLAN - BUILDING A
SCALE: 3/16"=1'-0"

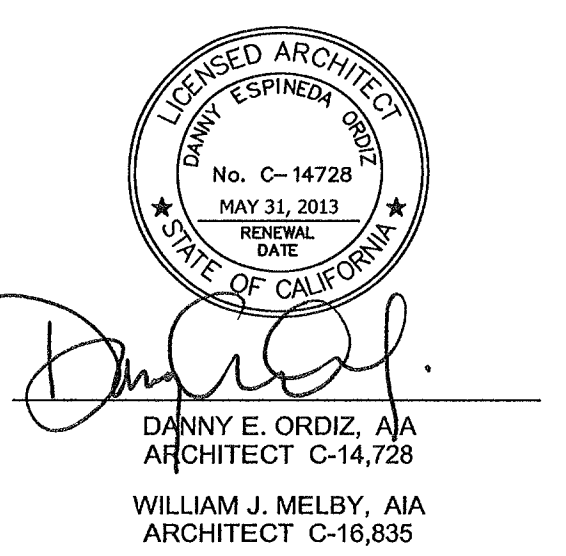
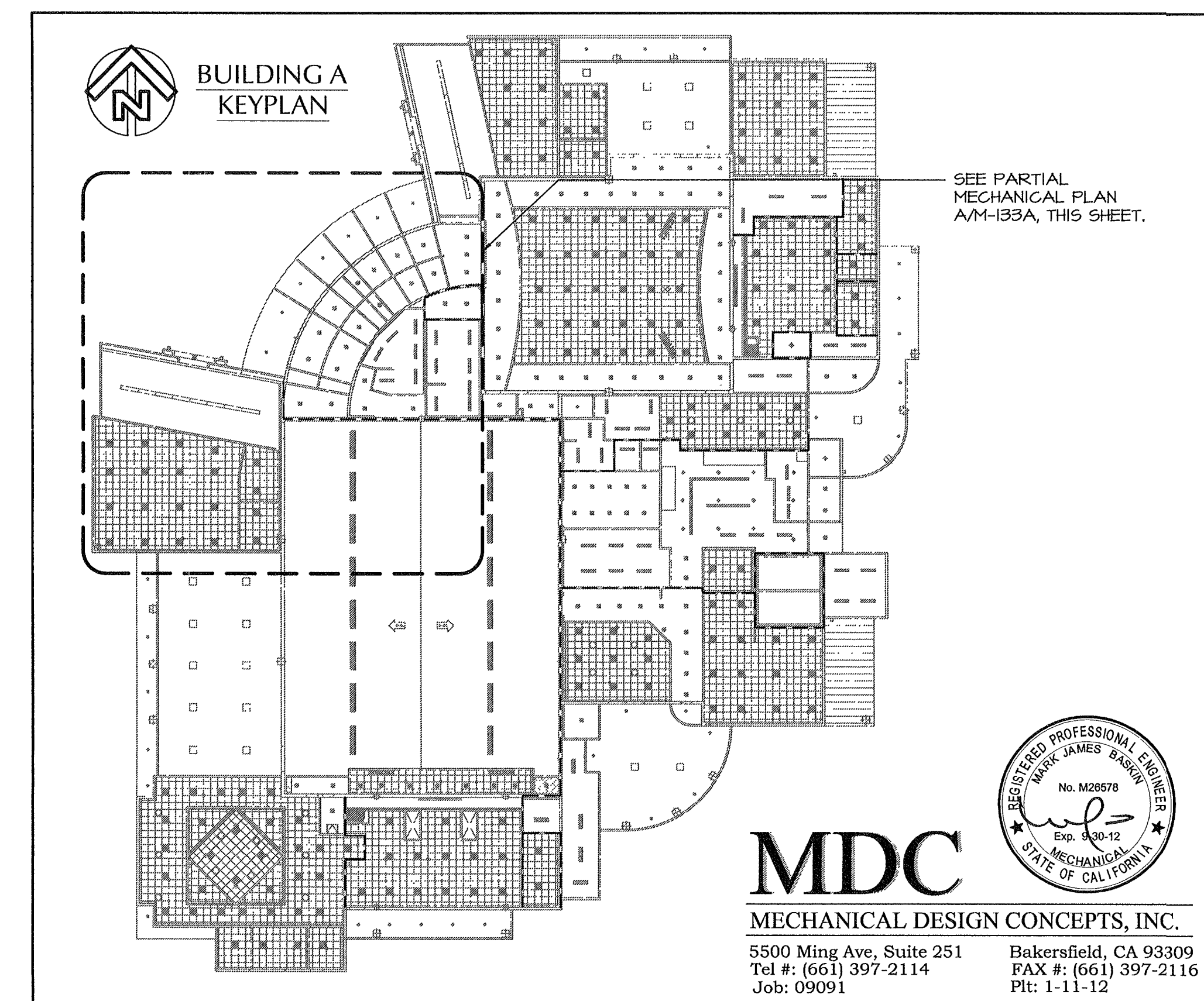

IDENTIFICATION STAMP
DIVISION OF STATE ARCHITECT
OFFICE OF REGULATION SERVICES
APPL. # 02-112027
FILE # 15-6
AC: [Signature] SS: GR
DATE: JAN 20 2012
PTN # 63321-112

**NEW ELEMENTARY
SCHOOL**
9801 HIGHLAND KNOLLS DR
BAKERSFIELD
CALIFORNIA
93306

NEW MIDDLE SCHOOL
4115 VINELAND ROAD
BAKERSFIELD
CALIFORNIA
93306

FOR:
**BAKERSFIELD CITY
SCHOOL DISTRICT**
1300 BAKER STREET
BAKERSFIELD
CALIFORNIA
93305

MARK	DATE	DESCRIPTION
△		
△		
△		
△		

JOB NUMBER
20010244
CAD DRAWING FILE

DRAWN BY:
KW
CHECKED BY:
MB

CHECK AND VERIFY ALL DIMENSIONS BEFORE
PROCEEDING WITH THE WORK.
REPORT DISCREPANCIES TO THE ARCHITECT.

THE DRAWINGS, IDEAS, AND DESIGNS
REPRESENTED ON THIS SHEET ARE THE
PROPERTY OF THE ARCHITECT.

COPYRIGHT
ORDIZ-MELBY ARCHITECTS, INC. 2010

SHEET TITLE
**PARTIAL
MECHANICAL PLAN
- BUILDING A**

SHEET IDENTIFICATION NUMBER
M-133A