

ORDIZ MELBY
ARCHITECTS, INC.

5500 MING AVENUE SUITE 280
BAKERSFIELD, CALIFORNIA 93309
TELEPHONE (661) 832-6268
FACSIMILE (661) 832-4261



DANNY E. ORDIZ, AIA
ARCHITECT C-14,728
WILLIAM J. MELBY, AIA
ARCHITECT C-16,636

IDENTIFICATION STAMP
DIVISION OF STATE ARCHITECT
OFFICE OF REGULATION SERVICES
APPL. #: 02-112027
FILE #: 15-6
AC FLS SS
DATE
PTN # 63321-112

NEW ELEMENTARY SCHOOL
9801 HIGHLAND KNOLLS DR
BAKERSFIELD, CALIFORNIA
93306

NEW MIDDLE SCHOOL
4115 VINELAND ROAD
BAKERSFIELD CALIFORNIA
93306

FOR:
BAKERSFIELD CITY SCHOOL DISTRICT

1300 BAKER STREET
BAKERSFIELD CALIFORNIA
93305

MARK	DATE	DESCRIPTION
2	05-16-12	Revision 2
4	05-29-12	Revision 4

200101244
CAD DRAWING FILE:
10021GP01
DRAWN BY:
SLLU
CHECKED BY:
RRJ
CHECK AND VERIFY ALL DIMENSIONS BEFORE
PROCEEDING WITH THE WORK.
REPORT DISCREPANCIES TO THE ARCHITECT.
THE DRAWINGS, DEAS, AND DESIGNS
REPRESENTED ON THIS SHEET ARE THE
PROPERTY OF THE ARCHITECT.
COPYRIGHT
ORDIZMELBY ARCHITECTS, INC. 2009
SHEET TITLE

UTILITY PLAN
SHEET IDENTIFICATION NUMBER
C9
SHEET OF

APR #003

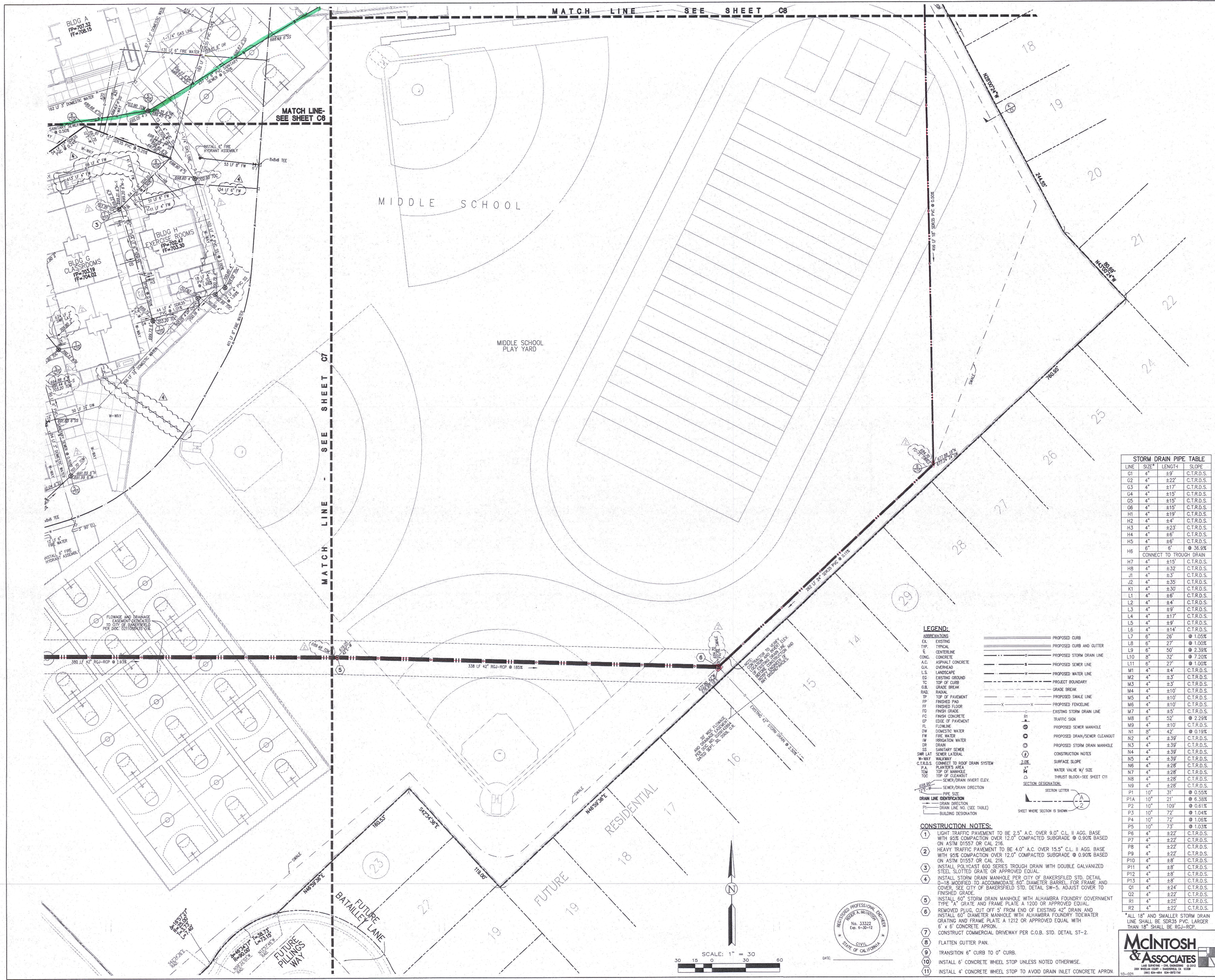

STORM DRAIN PIPE TABLE

LINE	SIZE"	LENGTH	SLOPE
G1	4"	±19'	C.T.R.D.S.
G2	4"	±22'	C.T.R.D.S.
G3	4"	±17'	C.T.R.D.S.
G4	4"	±15'	C.T.R.D.S.
G5	4"	±15'	C.T.R.D.S.
G6	4"	±15'	C.T.R.D.S.
H1	4"	±19'	C.T.R.D.S.
H2	4"	±4'	C.T.R.D.S.
H3	4"	±23'	C.T.R.D.S.
H4	4"	±6'	C.T.R.D.S.
H5	4"	±6'	C.T.R.D.S.
H6	6"	6'	① 36.5%
CONNECT TO TROUGH DRAIN			
H7	4"	±15'	C.T.R.D.S.
H8	4"	±32'	C.T.R.D.S.
J1	4"	±3'	C.T.R.D.S.
J2	4"	±35'	C.T.R.D.S.
K1	4"	±30'	C.T.R.D.S.
L1	4"	±6'	C.T.R.D.S.
L2	4"	±4'	C.T.R.D.S.
L3	4"	±9'	C.T.R.D.S.
L4	4"	±17'	C.T.R.D.S.
L5	4"	±9'	C.T.R.D.S.
L6	4"	±14'	C.T.R.D.S.
L7	6"	26'	① 1.05%
L8	6"	27'	① 1.00%
L9	6"	50'	① 2.39%
L10	8"	32'	① 7.20%
L11	6"	27'	① 1.00%
M1	4"	±4'	C.T.R.D.S.
M2	4"	±3'	C.T.R.D.S.
M3	4"	±3'	C.T.R.D.S.
M4	4"	±10'	C.T.R.D.S.
M5	4"	±10'	C.T.R.D.S.
M6	4"	±10'	C.T.R.D.S.
M7	4"	±5'	C.T.R.D.S.
M8	6"	52'	① 2.29%
M9	4"	±10'	C.T.R.D.S.
N1	8"	42'	① 0.19%
N2	4"	±39'	C.T.R.D.S.
N3	4"	±39'	C.T.R.D.S.
N4	4"	±39'	C.T.R.D.S.
N5	4"	±39'	C.T.R.D.S.
N6	4"	±28'	C.T.R.D.S.
N7	4"	±28'	C.T.R.D.S.
N8	4"	±28'	C.T.R.D.S.
N9	4"	±28'	C.T.R.D.S.
P1	10"	31'	① 0.55%
P1A	10"	21'	① 6.38%
P2	10"	109'	① 0.61%
P3	10"	72'	① 1.04%
P4	10"	72'	① 1.05%
P5	10"	73'	① 1.03%
P6	4"	±22'	C.T.R.D.S.
P7	4"	±22'	C.T.R.D.S.
P8	4"	±22'	C.T.R.D.S.
P9	4"	±22'	C.T.R.D.S.
P10	4"	±8'	C.T.R.D.S.
P11	4"	±8'	C.T.R.D.S.
P12	4"	±8'	C.T.R.D.S.
P13	4"	±8'	C.T.R.D.S.
Q1	4"	±24'	C.T.R.D.S.
Q2	4"	±22'	C.T.R.D.S.
R1	4"	±25'	C.T.R.D.S.
R2	4"	±22'	C.T.R.D.S.

LEGEND:

ABBREVIATIONS:
EX. EXISTING
TP. TYPICAL
C. CENTERLINE
CONC. CONCRETE
A.C. ASPHALT CONCRETE
O.H. OVERHEAD
L.S. LANDSCAPE
EG. EXISTING GROUND
TC. TOP OF CURB
G.B. GRADE BREAK
RAD. RADIAL
TP. TOP OF PAVEMENT
FF. FINISHED FLOOR
FC. FINISH CONCRETE
EP. EDGE OF PAVEMENT
FL. FLOWLINE
DW. DOMESTIC WATER
FW. FIRE WATER
IW. IRRIGATION WATER
DR. DRAIN
SS. SANITARY SEWER
SNR LAT. SEWER LATERAL
W-WAY. WALKWAY
C.T.R.D.S. CONNECT TO ROOF DRAIN SYSTEM
P.A. PLANTER'S AREA
TOP OF MANHOLE
TOC. TOP OF CLEANOUT
SSR. SEWER DRAIN INVERT ELEV.
S.D. SEWER DRAIN DIRECTION
P. PIPE SIZE
DRAIN LINE IDENTIFICATION
DRAIN DIRECTION
DRAIN LINE NO. (SEE TABLE)
BUILDING DESIGNATION

PROPOSED CURB
PROPOSED CURB AND GUTTER
PROPOSED STORM DRAIN LINE
PROPOSED SEWER LINE
PROPOSED WATER LINE
PROJECT BOUNDARY
GRADE BREAK
PROPOSED SWALE LINE
PROPOSED FENCELINE
EXISTING STORM DRAIN LINE
TRAFFIC SIGN
PROPOSED SEWER MANHOLE
PROPOSED DRAIN/SEWER CLEANOUT
PROPOSED STORM DRAIN MANHOLE
CONSTRUCTION NOTES
SURFACE SLOPE
WATER VALVE W/ SIZE
THRUST BLOCK-SEE SHEET C11

SECTION DESIGNATION:
SECTION LETTER

- CONSTRUCTION NOTES:**
- LIGHT TRAFFIC PAVEMENT TO BE 2.5" A.C. OVER 9" C.L. II AGG. BASE WITH 95% COMPACTION OVER 12.0" COMPACTED SUBGRADE @ 0.90% BASED ON ASTM D1557 OR CAL 216.
 - HEAVY TRAFFIC PAVEMENT TO BE 4" A.C. OVER 15.5" C.L. II AGG. BASE WITH 95% COMPACTION OVER 12.0" COMPACTED SUBGRADE @ 0.90% BASED ON ASTM D1557 OR CAL 216.
 - INSTALL POLYCAST 600 SERIES TROUGH DRAIN WITH DOUBLE GALVANIZED STEEL SLOTTED GRATE OR APPROVED EQUAL.
 - INSTALL STORM DRAIN MANHOLE PER CITY OF BAKERSFIELD STD. DETAIL D-18, MODIFIED TO ACCOMMODATE 60" DIAMETER BARREL FOR FRAME AND COVER. SEE CITY OF BAKERSFIELD STD. DETAIL SW-5, ADJUST COVER TO FINISHED GRADE.
 - INSTALL 60" STORM DRAIN MANHOLE WITH ALHAMBRA FOUNDRY GOVERNMENT TYPE "A" GRATE AND FRAME PLATE A 1200 OR APPROVED EQUAL REMOVED PLUG, CUT OFF 5' FROM END OF EXISTING 42" DRAIN AND INSTALL 60" DIAMETER MANHOLE WITH ALHAMBRA FOUNDRY TIDEWATER GRATING AND FRAME PLATE A 1212 OR APPROVED EQUAL WITH 6" x 6" CONCRETE APRON.
 - CONSTRUCT COMMERCIAL DRIVEWAY PER C.O.B. STD. DETAIL ST-2.
 - FLATTEN GUTTER PAN.
 - TRANSITION 6" CURB TO 0" CURB.
 - INSTALL 6" CONCRETE WHEEL STOP UNLESS NOTED OTHERWISE.
 - INSTALL 4" CONCRETE WHEEL STOP TO AVOID DRAIN INLET CONCRETE APRON.



SCALE: 1" = 30'