

FREMONT ELEMENTARY SCHOOL GRADING AND SITE IMPROVEMENT PLANS FOR NEW CLASSROOM PORTABLES

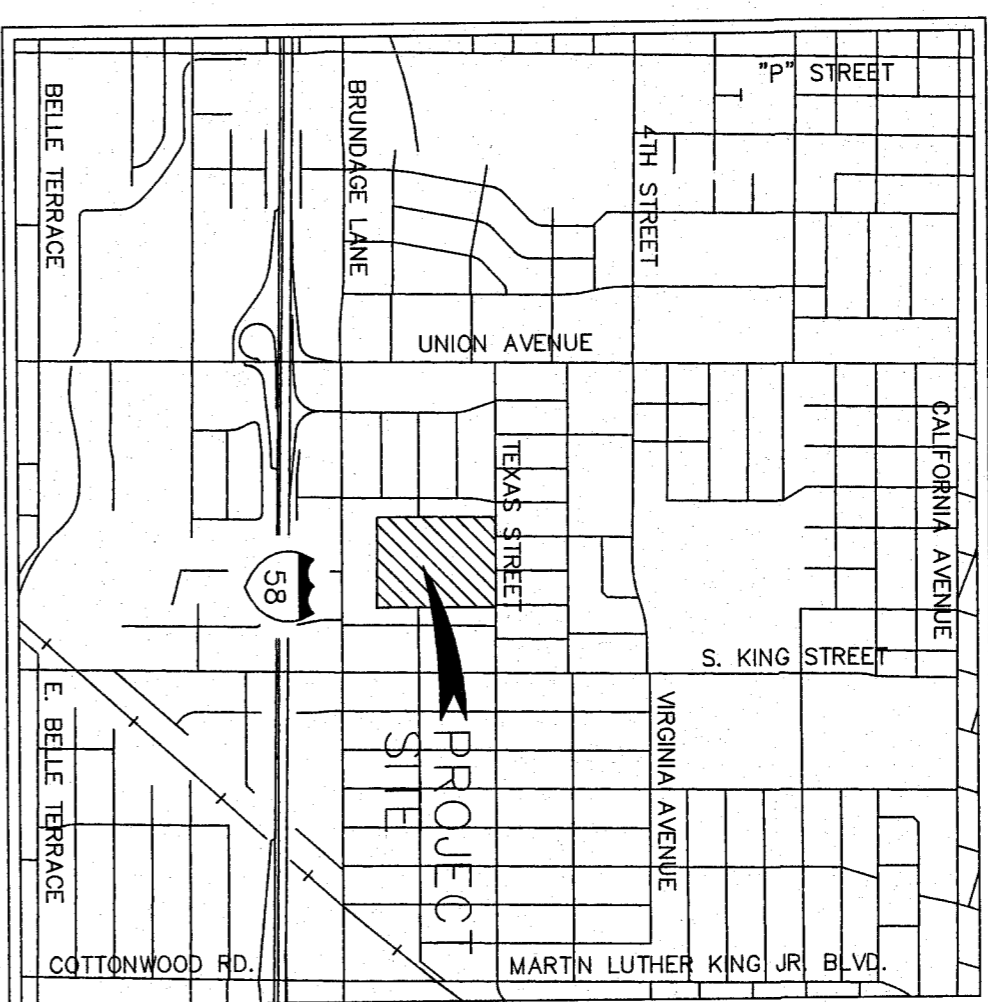

VICINITY MAP
NO SCALE

BENCHMARK USED:
FLOWLINE OF EXISTING CURB AND GUTTER, SOUTH SIDE OF TEXAS STREET, NEAR THE EAST LINE OF FREMONT SCHOOL AND SHOWN ON THIS MAP AS PROJECT BENCH MARK.
ELEVATION = 100.00 (ASSUMED)

- STATISTICS:**
1. ASSESSOR'S PARCEL NUMBER: 139-440-01
 2. APPROXIMATE AVERAGE: 0.95 ACRES
 3. BUILDING SIZE: APPROXIMATELY 13,440 S.F.
 4. WATER: ON-SITE
 5. SEWER DISPOSAL: ON-SITE
 6. DRAINAGE: ON-SITE
 7. EXISTING LAND USE: SCHOOL SITE
 8. EXISTING AND SITE SCHOOL SITE
 9. FIRE PROTECTION: C.O.B.
 10. ADDRESS: 607 TEXAS STREET BAKERSFIELD, CA 93307

- SHEET NO. INDEX**
- 1 COVER SHEET
 - 2 IMPROVEMENT & GRADING NOTES
 - 3 DETAILS AND TYPICAL SECTIONS
 - 4 STANDARD PLAN DETAILS
 - 5 EXISTING CONDITIONS & DEMOLITION
 - 6 GRADING AND SITE IMPROVEMENT PLANS - NEW CLASSROOMS
 - 7 GRADING AND SITE IMPROVEMENT PLANS - NEW CLASSROOMS
 - 8 UTILITY PLANS (SEWER & WATER)
 - 9 UTILITY PLANS (SEWER & WATER)

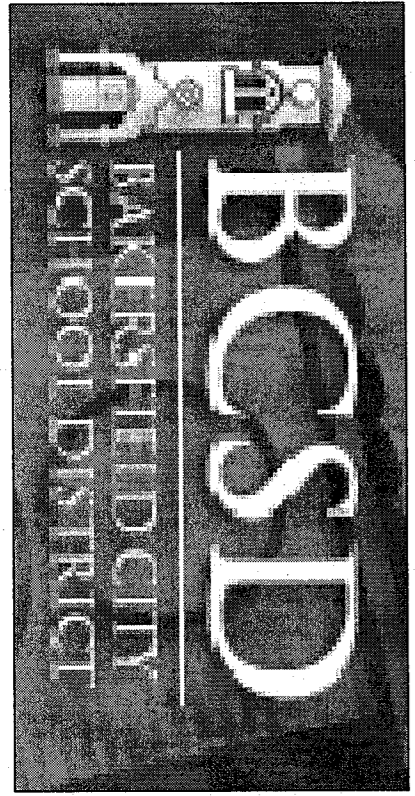
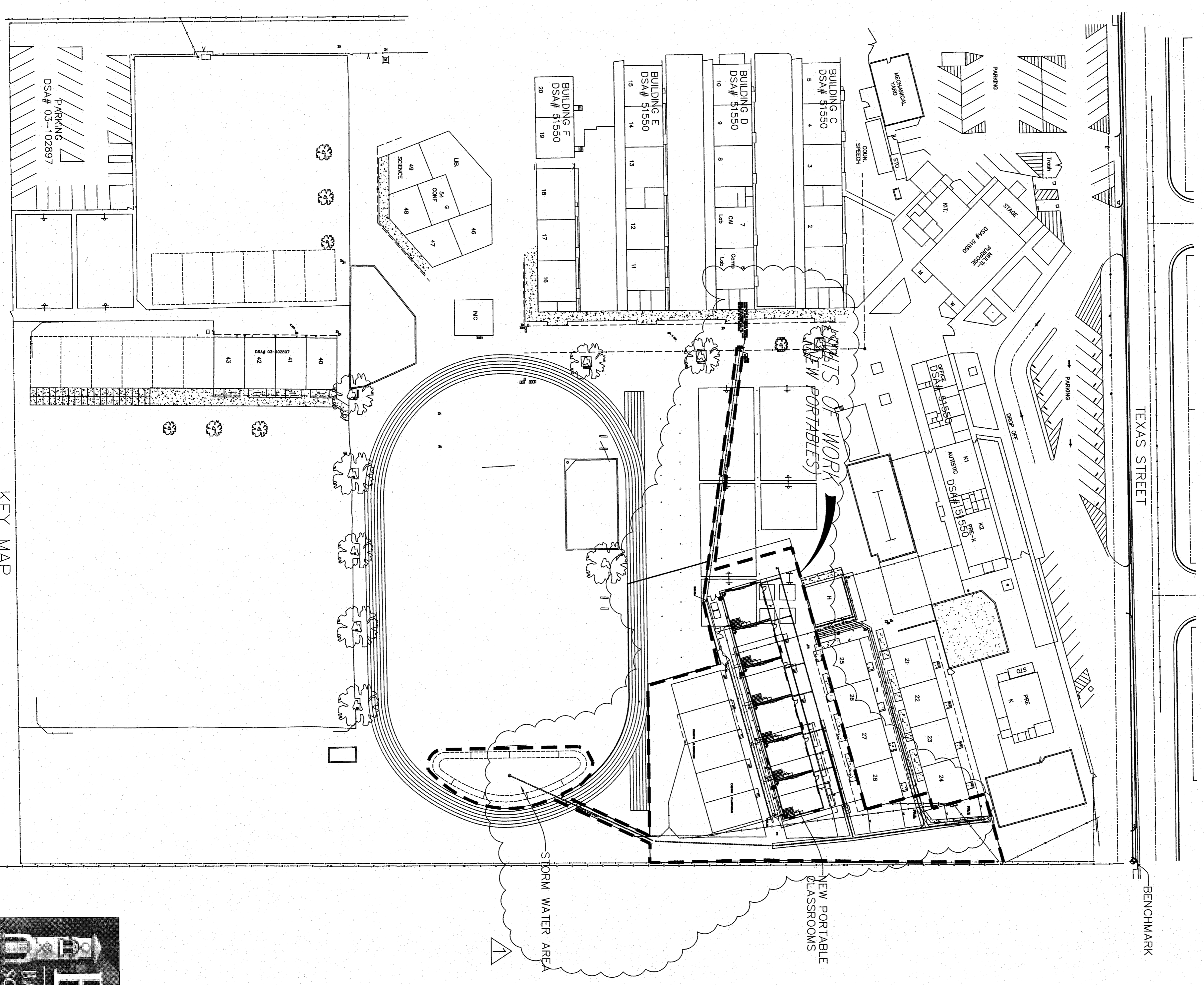

AS BUILT

COVER SHEET
FREMONT ELEMENTARY
607 TEXAS STREET
BAKERSFIELD, CALIFORNIA

<i>Matthew K. Vovilla</i>	
MATTHEW K. VOVILLA	RCE 43130 EXP. 3/31/12
REVISIONS	DATE
▲ CHANGE ORDER ONE	

Pinnacle Civil Engineering, Inc.

4620 California Avenue, Bakersfield, CA 93309
Phone: (661) 869-0184 Fax: (661) 377-0076

JOB NO.: 08-288	DATE: 08-28-08
DRWING NO.: 08-288-BM03	DATE: 5/11/2010
DRWING BY: ADK	CHECKED BY: MKV
SHEET 1	OF 9 SHEETS