

**\* COMMON WIRE NAILS**

Mark	Length	Plywood	Dimension	Quantity	Notes
1	4" x 0	5/8"	8" x 4"	1	
2	4" x 0	5/8"	8" x 4"	1	
3	4" x 0	5/8"	8" x 4"	1	
4	4" x 0	5/8"	8" x 4"	1	
5	4" x 0	5/8"	8" x 4"	1	
6	4" x 0	5/8"	8" x 4"	1	
7	4" x 0	5/8"	8" x 4"	1	
8	4" x 0	5/8"	8" x 4"	1	
9	4" x 0	5/8"	8" x 4"	1	
10	4" x 0	5/8"	8" x 4"	1	
11	4" x 0	5/8"	8" x 4"	1	
12	4" x 0	5/8"	8" x 4"	1	
13	4" x 0	5/8"	8" x 4"	1	
14	4" x 0	5/8"	8" x 4"	1	
15	4" x 0	5/8"	8" x 4"	1	
16	4" x 0	5/8"	8" x 4"	1	
17	4" x 0	5/8"	8" x 4"	1	
18	4" x 0	5/8"	8" x 4"	1	
19	4" x 0	5/8"	8" x 4"	1	
20	4" x 0	5/8"	8" x 4"	1	

NOTE: Use 5/8" dia. to 6/8" dia. for 1/2" dia. studs.

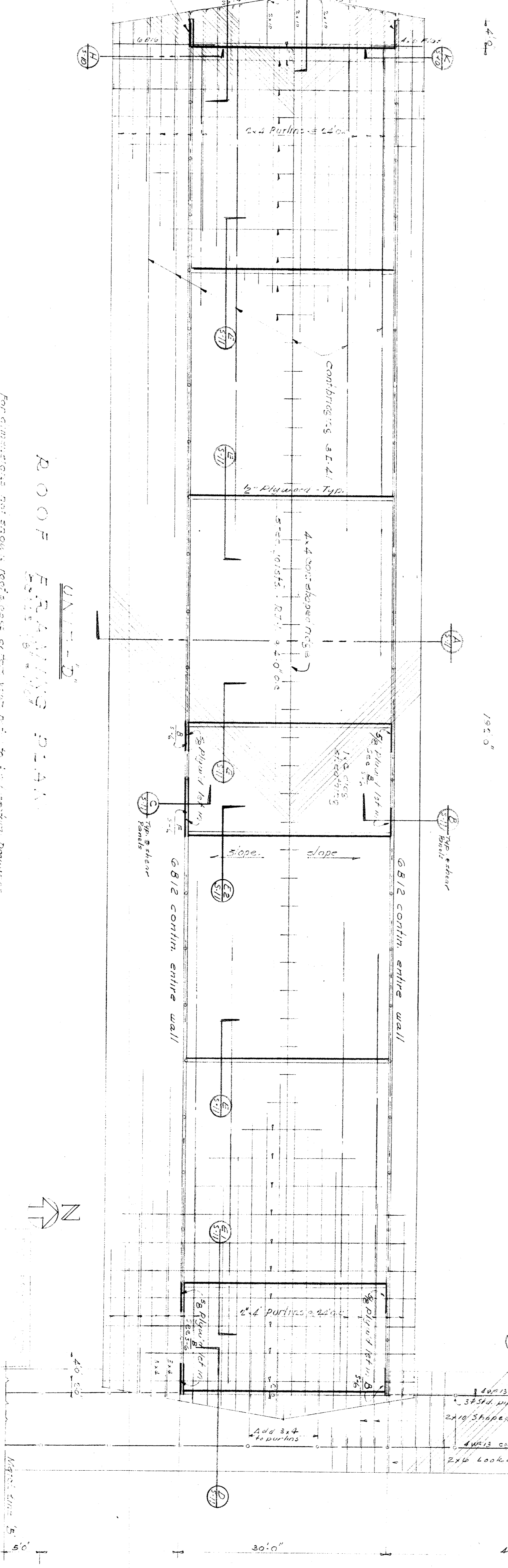
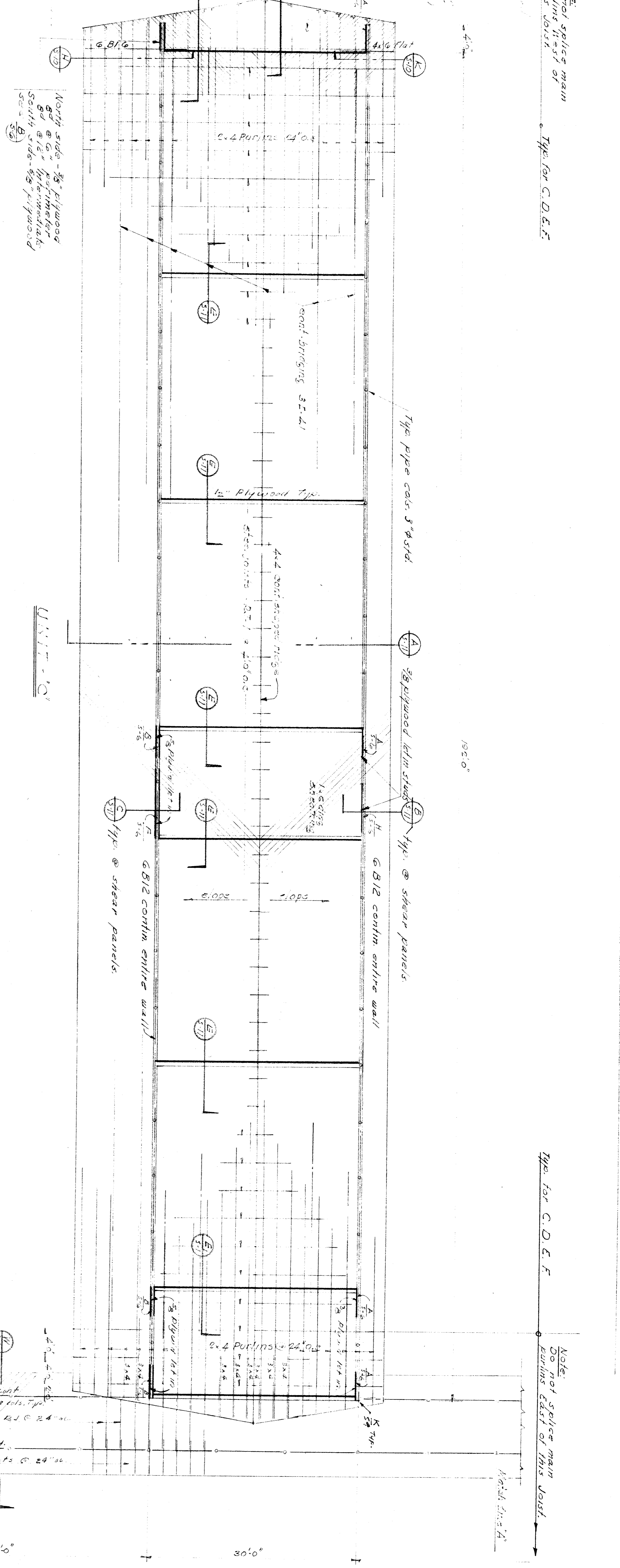
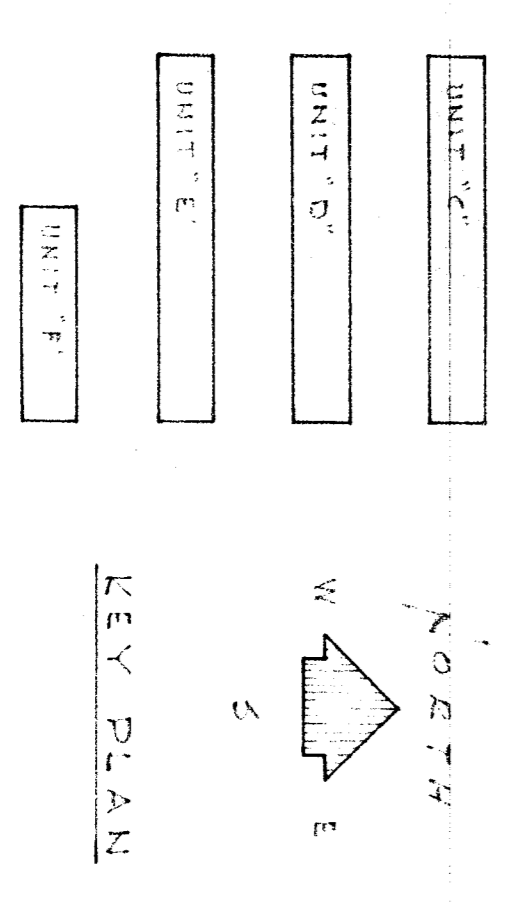

**ROOF FRAMING PLAN**

FOR INFORMATION: THIS DRAWING IS A PART OF THE ROOF FRAMING PLAN FOR THE UNIT A AND B OF THE SCHOOL DISTRICT. ALL DIMENSIONS ARE IN FEET AND INCHES. DRAWINGS BY: [Signature]

CHIEF DIVISION OF ARCHITECTURE ARCHITECTS  
DATE 10 2 53

KEAN COUNTY SUPR OF SCHOOLS  
EMERSON CITY SCHOOL DISTRICT  
BOARD OF EDUCATION  
APPROVED: [Signature]  
DATE: [Date]