

MATCH LINE "B" SEE SHEET E-6

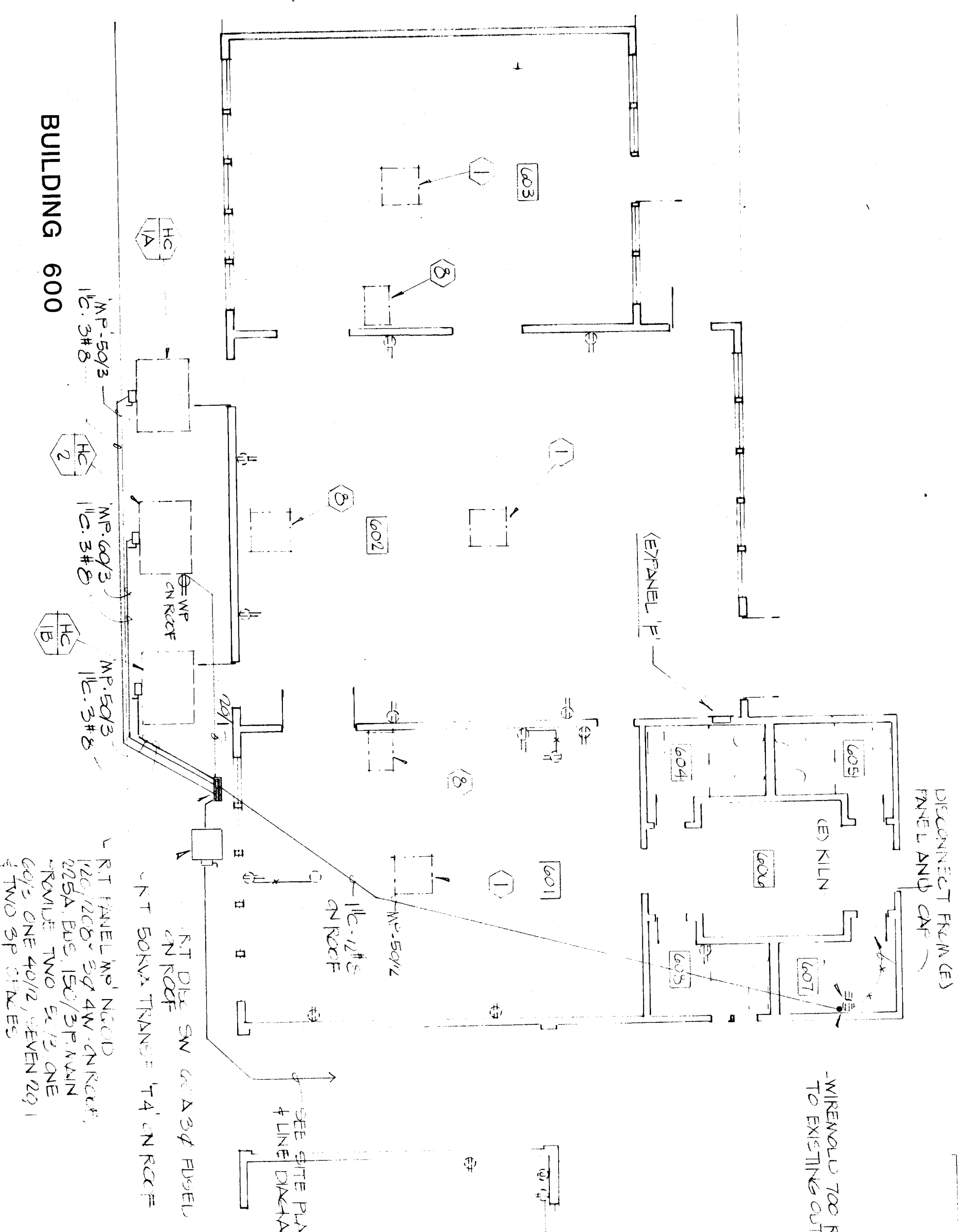
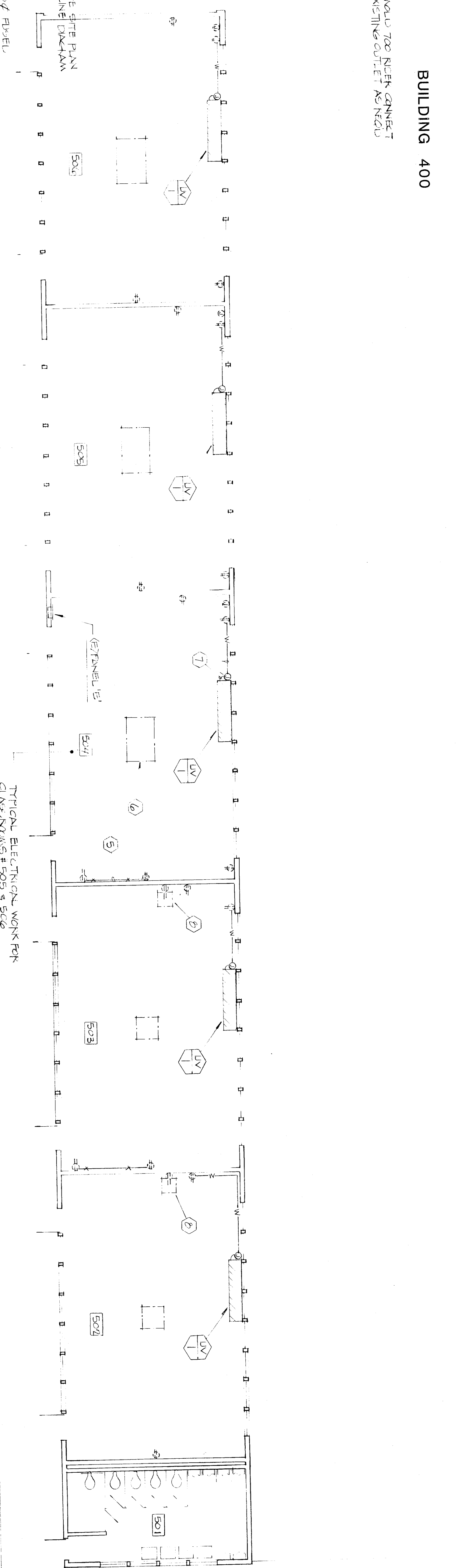
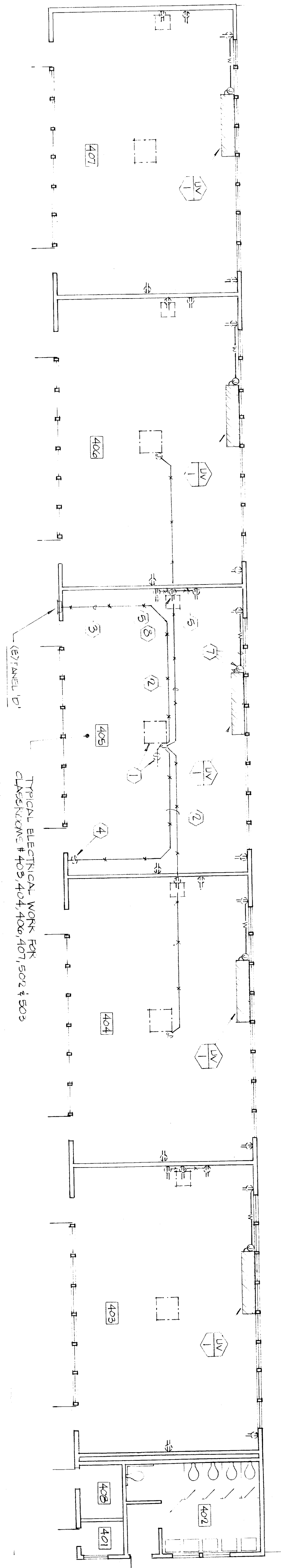

POWER FLOOR PLANS

1/8" = 1'-0"

- REFERENCE NOTES (THIS SHEET ONLY):
- 1) REMOVE EXISTING EVAP. COOLER THERO-SWITCH.
 - 2) REMOVE EXISTING RACEWAY.
 - 3) DISCONNECT EXISTING CIRCUIT AND CAP CONDUIT.
 - 4) REMOVE EXISTING SWITCH AND SURFACE WIREWOUND.
 - 5) EXISTING WIREWOUND TO REMAIN.
 - 6) DISCONNECT ELECTRICAL TO AIR CONDITIONING AND CAP CONDUIT AT BOTH ENDS.
 - 7) SURFACE WIREWOUND BOX AND 500 RACEWAY WITH TWO #12 FROM UNIT VENTILATOR. PULL WIRE BACK TO EXISTING PANEL VIA EXISTING HOOROM AND CONNECT TO EXISTING EVAP. COOLER BREAKER.
 - 8) DISCONNECT EXISTING POWER TO FURNACE.

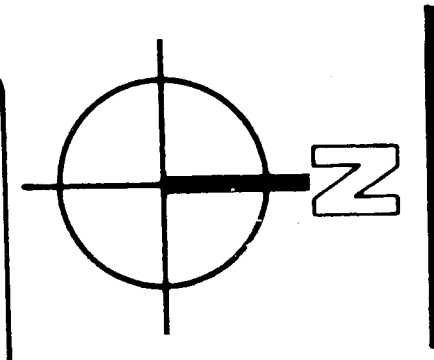
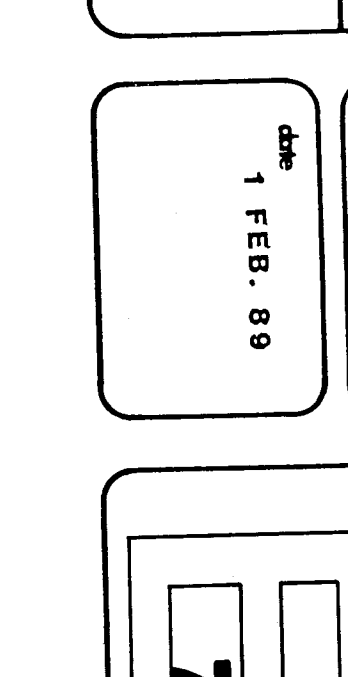
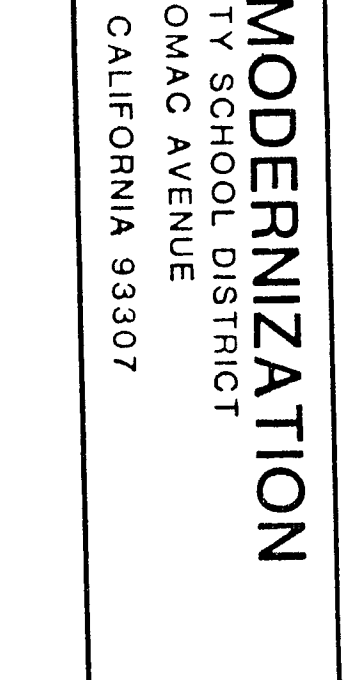
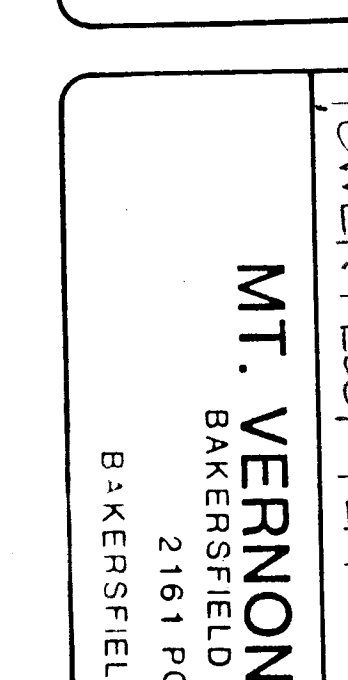
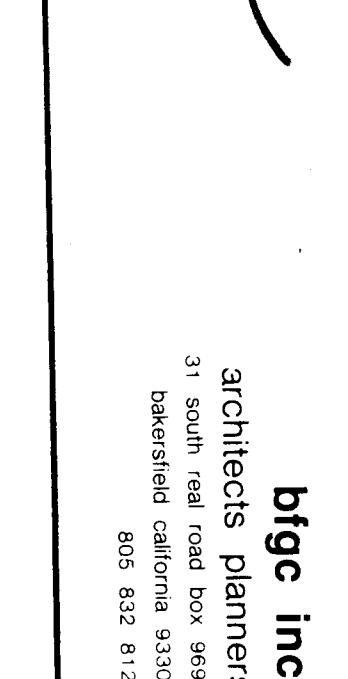
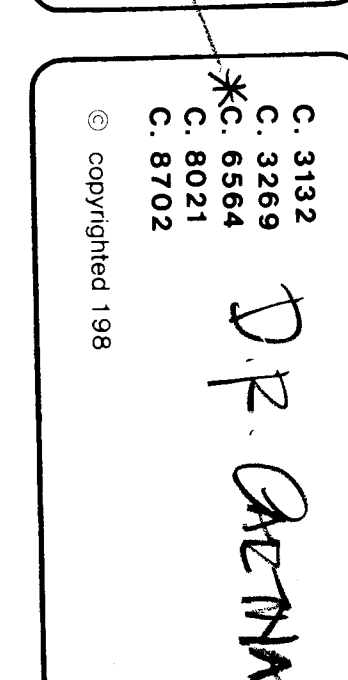
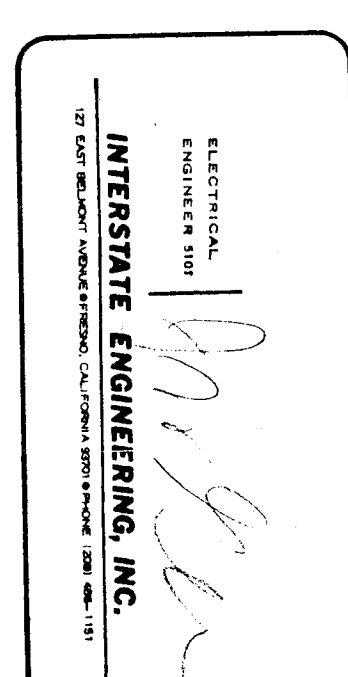
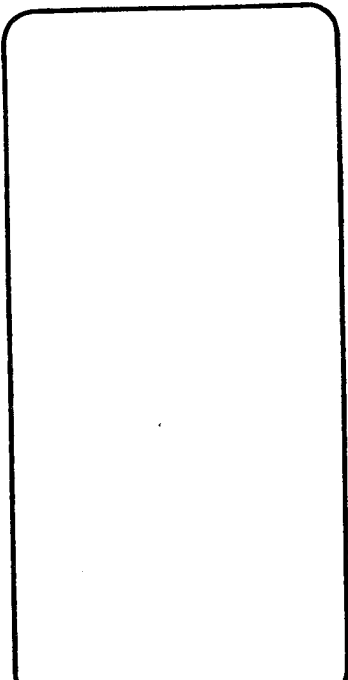
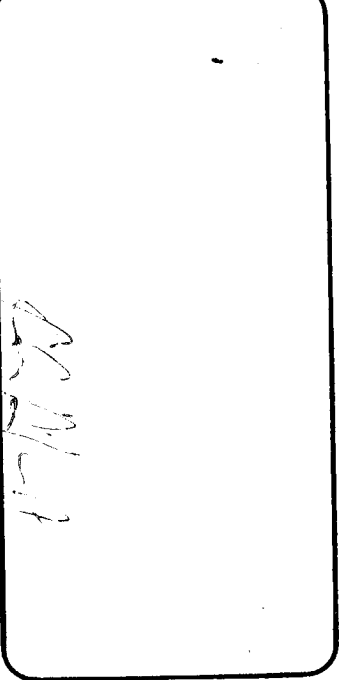
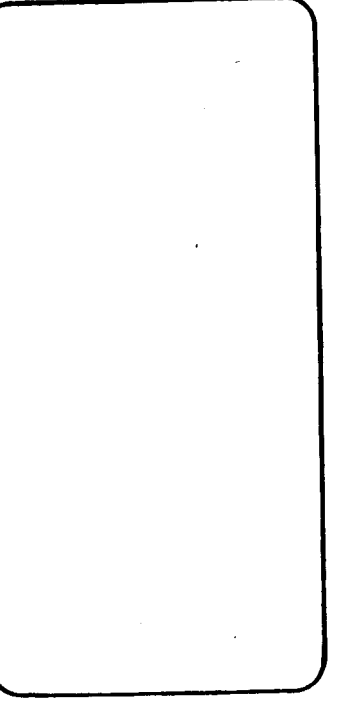
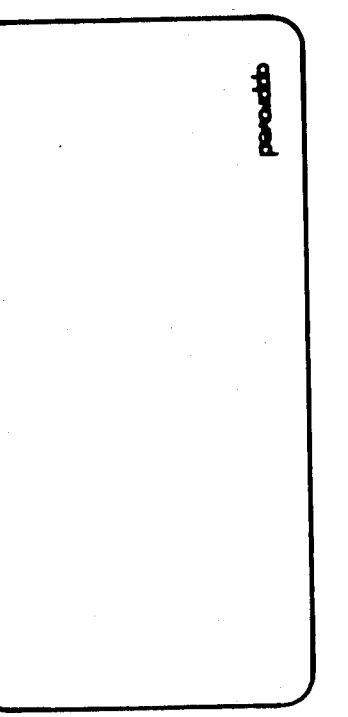

architects - planners

APPLICATION NO. 77/50602
 POWER FLOOR PLANS - BUILDINGS 400, 500 & 600
MT. VERNON MODERNIZATION
 BAKERSFIELD CITY SCHOOL DISTRICT
 2101 POTOMAC AVENUE
 BAKERSFIELD, CALIFORNIA 93307

DATE: 87-126
 1 FEB. 89

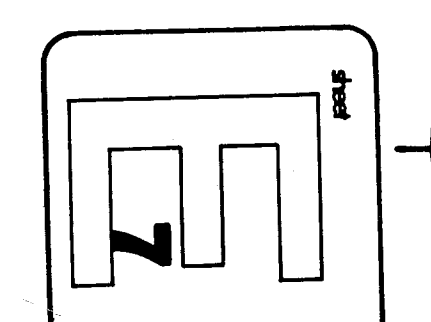

C 3132
 C 3269
 C 5564
 C 8021
 C 8702
 © Copyright 1988

D.P. Aetna

architects planners
bfgc inc.
 31 South Hill Road Box 9888
 Bakersfield California 93309
 805.532.9121